

Outdoor living

Buying guide 2022



All the products (shown here) may not be available at the store. Please contact the staff or look at www.IKEA-USA.com for more information. For more detailed product information, see the price tag and the internet. All units require assembly.





Outdoor dining see page 14



Outdoor lounging and relaxing see page 38



Outdoor cooking see page 96



Gardening see page 102

Table of contents

Live more outdoors	4	Outdoor comfort cushions	68
Serve up fun	6	Decorative cushions and throws	74
Take it easy	8	Umbrellas, canopy and privacy screens	78
How to furnish your outdoor space	10	Outdoor lighting	84
Outdoor dining	14	Outdoor flooring and rugs	88
Meet our favorites.....	16	Outdoor cooking	96
The story of BONDHOLMEN	18	Go classic with charcoal.....	98
Dining sets.....	20	Gardening	102
Dining chairs, stools and benches	26	Outdoor storage and organizing	108
Dining cushions — how to choose	29	Outdoor laundry	112
Dining tables	30	Maintenance	116
Children’s outdoor furniture	34	Protect your outdoor pieces	118
Outdoor lounging and relaxing	38	Made outdoor strong	120
Find your outdoor modular sofa style	40	Relax, we can help	122
SOLLERÖN modular sofa.....	42	Furniture for you and the environment	124
ÄPPLARÖ modular sofa	50		
HAVSTEN sofa.....	56		
JUTHOLMEN modular sofa	60		
Outdoor armchairs, sofas, tables and pouffes...	62		
Outdoor chaises, beach chairs, and more.....	66		



Live more outdoors

Dreaming of a nap in the sun? A refreshing snack with friends? A moment alone in the shade? Your dream is waiting at home, in whatever size space you have. With your imagination and our wide outdoor offering, your dream is covered, whether it's about dining, lounging, cooking, gardening, storing or having laundry help. Let's see what your outdoors can do.



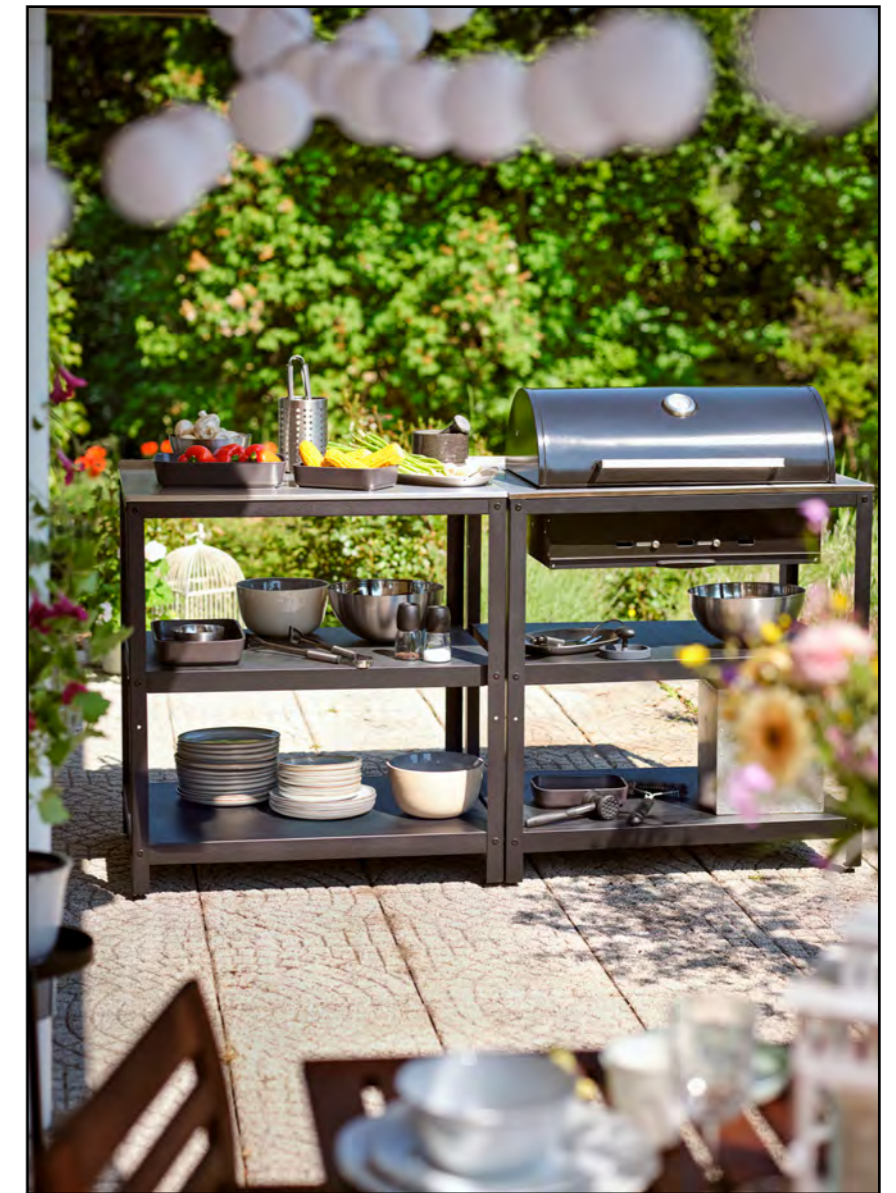

Serve up fun

There's something memorable about being outdoors while cooking a meal and spending time together. It's like food tastes better in the sunshine. Maybe it's being closer to nature — we're not sure. But we are sure that from dining tables and chairs to barbecues and gardening stuff, we have all you need to enjoy cooking and eating outdoors. Plus, it's all under one roof, whether you'll put it under a roof or not!



Take it easy

When you're outdoors, it's easier to slow down and practice the art of doing nothing. Whether you're on your balcony, at the beach or in your garden, you can make the outdoors all yours. From modular sofas, hammocks and chaises to umbrellas, lights, textiles and everything in between, we have what you want in styles you'll love for an outdoor oasis you won't want to leave.

How to furnish your outdoor space

You'll be spending time in your great outdoors in no time! Get started exploring the possibilities with these general tips. The next page has specific info for smaller and larger spaces. Remember the furniture and pieces we're talking about are those designed for outdoor use – and they're all in this buying guide. Sketch a floorplan with dimensions as a handy tool to figure out what fits. Then follow our helpful hints:

Save time and space

If you use your space occasionally or if you want a nice space without investing much time and energy: Choose light-weight, stackable or foldable pieces that are easy to bring indoors. Protect them with water-proof covers if you can't store indoors.

Plants and flowers

Plants and flowers bring nature closer to you. Artificial plants have the same effect if the weather (or your desire) isn't growing friendly.

Rugs and flooring

Rugs and flooring can change your space's look. They help make whatever "ground" you have more comfortable and your space easier to clean.

Lighting

Lighting encourages being outdoors as much as possible in dark nights and seasons. It adds ambience and looks nice even when you're indoors.

Cushions

Cushions show off your personality. Mix and match colors, sizes and patterns on sofas and chairs for decorative touches and soft, supportive padding. Protect them in storage bags/box when not in use.

Follow your style

Extend your indoor style to your outdoors. This creates a strong visual and emotional connection.

Material matters

Material choice is tied to likes, wants and needs. If you like wood, remember it needs some maintenance every now and then. Plastic, steel and aluminum are easy-care options.

If your space is exposed to lots of sun or moisture: Protect your furniture as much as possible. This is especially true for wood but also applies to steel, plastic and aluminum – even though these materials better withstand sun and moisture. Regardless of material, protecting furniture helps it last longer.

Shade and protection

If you need shade/protection from ultraviolet rays or if you want privacy: Look for umbrellas, canopies, nets, or privacy screens to suit your needs.

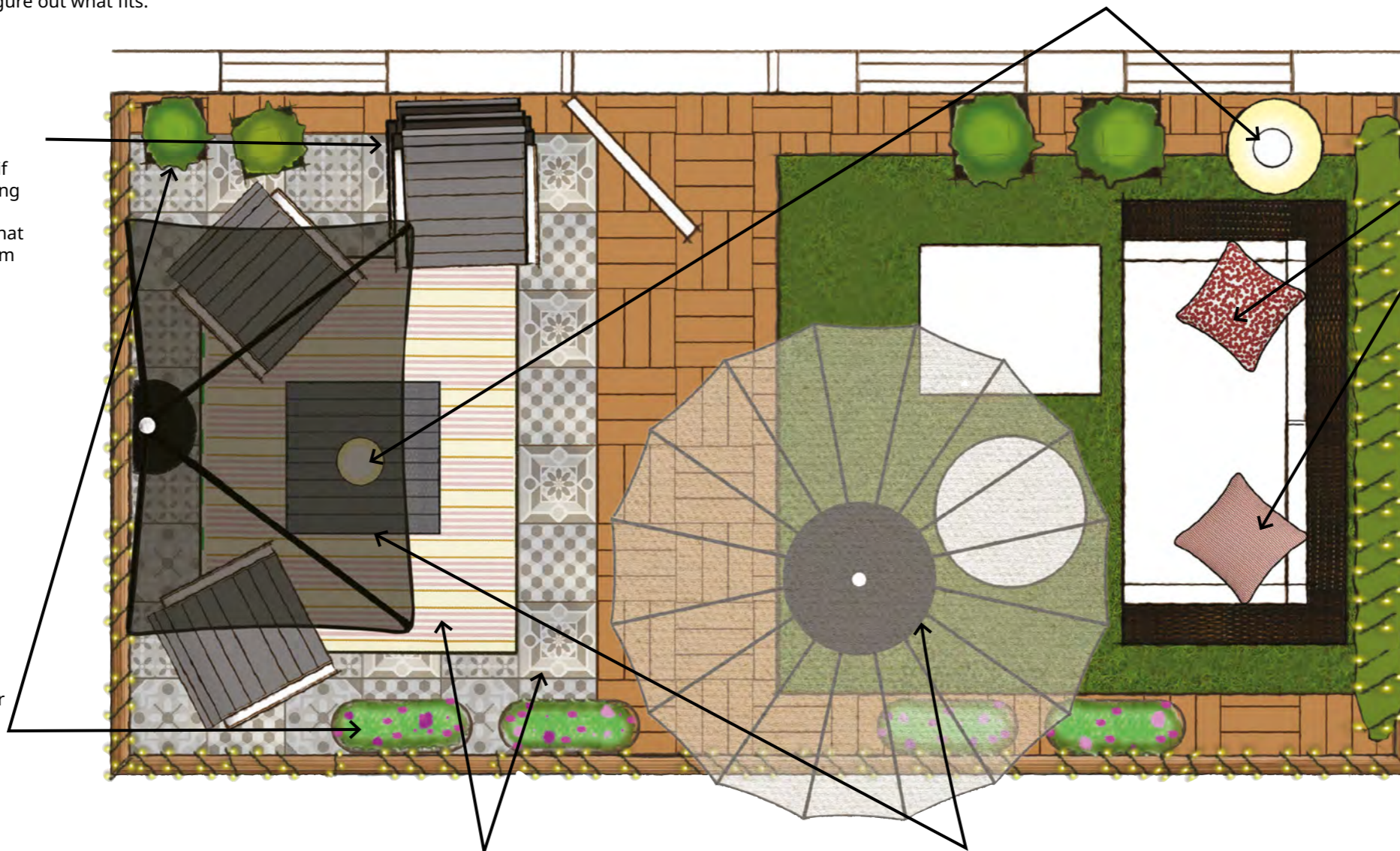

How to furnish a smaller space



No outdoor space is too small for watching the clouds come and go. The most important smaller space furnishing advice is ask yourself what you like to do. How about nap, read a book, exercise, eat, hang out?

Which of these can you — and would you love to — do in your smaller space?

1. Enjoy me-time or socialize a bit

Your favorite comfy seating is key — armchair, small sofa, reclining chair, hammock? Once you're covered, add options for guests like foldable chairs, stackable stools and pouffes. With a modular one-seat section and stool, you get a chaise that doubles as separate seats for you and a friend whenever needed.

2. Savour your meals

Start with a two-seat dining set. If you don't have room for a set, buy individually. A stool as side table or even a storage bench works if you just want a spot for a snack or drink.

3. Store your necessities

If you can fit a storage bench, you'll get seating (and a side table), too. Boxes, hooks, shelving units and cabinets are also good helpers to keep things outdoors like laundry pegs and hangers.

All the above!

If you can dream it, you can do it. Prioritize what you do (or want to do) the most. Creating space for your favorite activity means you're more likely to truly use your outdoors as part of your home.

How to furnish a larger space

For a larger outdoor space as comfy as your most-loved indoor space:

1. Set up the centerpiece

Choose and position your largest furniture first — like a modular sofa or dining table. This way you know it fits. Then work around it as a focal point.

2. Create activity zones

Arrange pieces into areas based on relaxing, dining, cooking, playing, etc. To enhance the room-within-a-room feel, use rugs, flooring, lighting, and privacy screens.

3. Make everyone feel at home

Give your family and your guests options. Think lots of seating, cushions and places to put their things. Remember children have their own needs, too.

4. Keep things close

Spend less time running back indoors. Shelving units, storage benches, cabinets, boxes and hooks can conveniently hold serveware, cushions, toys and more.



In a larger outdoor space, there are many possibilities. To help narrow your options, think about your favorite indoor spot. What makes it cozy and functional? Repeat as much as you can outdoors!

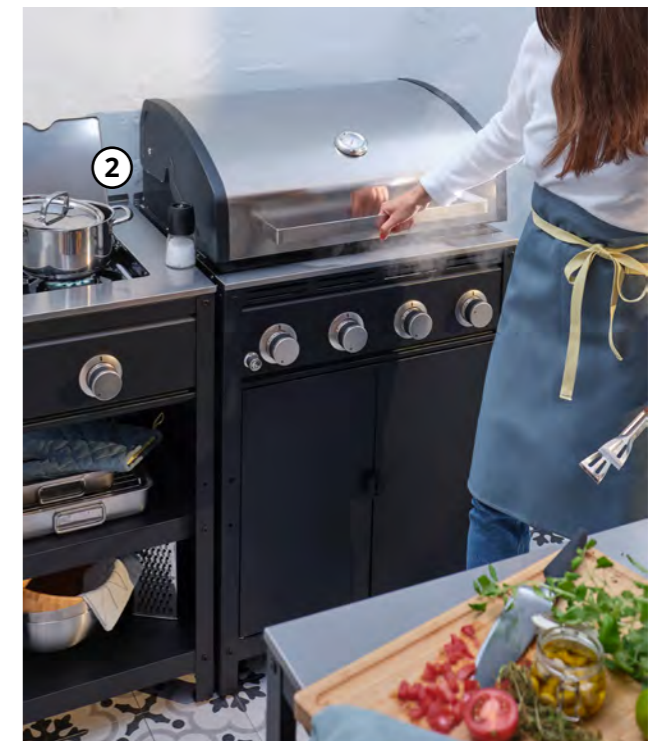

Outdoor dining

Create a dining recipe

Nightly treats on the balcony. Weekend brunches on the patio. With an outdoor dining solution, you always have an open table with good views and great company. We have tables, chairs, benches and stools that will fit your needs and dreams in any size or type of outdoor space. You can get the look you want and the level of maintenance you desire, too, since we offer lots of styles, colors and materials. No matter what you choose, your outdoor meals will surely include some greens!



Meet our favorites

Ready to dive into the world of outdoor dining furniture, but don't know where to start? We've collected some of our favorite families here, so you can get an overview of their looks and benefits. Then you can learn more about functions, sizes, materials, colors and prices on the following pages to create the dining combination that's right for you.



ÄPPLARÖ is made from durable, sustainably sourced acacia and has options for all spaces, like foldable pieces for small balconies and extendable tables for large yards. We have a little extra love for ÄPPLARÖ — just don't tell the other outdoor furniture! Why? It's our biggest series that can do it all from dining and cooking to lounging and storing. For seating, there are foldable chairs and stools, armchairs, reclining chairs, chaises, benches, bar stools and modular sofas. Tables come in different functions and sizes like gateleg, drop-leaf, square, bar and ones designed for balcony walls.

There's a cart, storage bench and a wall panel, too, so you can prep and serve food and keep everything tidy and organized. If you're lost in a sea of outdoor choices, we think ÄPPLARÖ is a pretty good start — especially since you can always add more pieces if your needs and dreams change.



SJÄLLAND has high personalization and low maintenance with durable options in eucalyptus, aluminum and glass. It has two sizes to fit larger and smaller spaces.



BONDHOLMEN is our dining and lounging series in a traditional style, inspired by how furniture was made in the past, with handcraft details and generous dimensions. Made of high-quality, sustainably sourced eucalyptus that is stained gray for beauty and added protection. Read more about the story of BONDHOLMEN on pg.18.

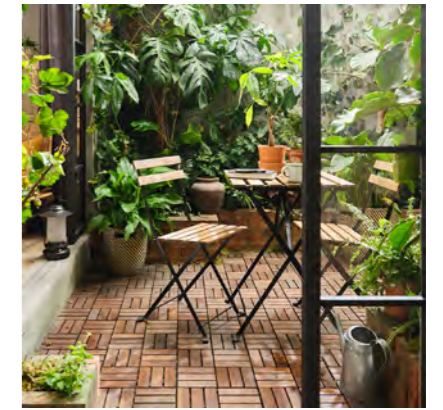

TÄRNÖ is foldable, durable and lovable with its mix of durable, sustainably sourced hardwood acacia and powder-coated steel. The wood is stained light brown for beauty and added protection.

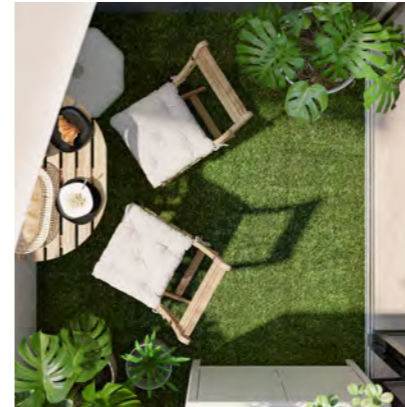

ASKHOLMEN is made of durable, sustainably sourced hardwood acacia stained light brown for beauty and added protection. It has foldable pieces to suit small balconies, too.



FALHOLMEN is made of durable, sustainably sourced hardwood acacia stained light brown for beauty and added protection. The chair can be stacked, which helps you save space.



SUNDSÖ is perfect for your balcony or other smaller spaces since it can be easily folded and put away. Comes pre-assembled — and is also suitable for business use.

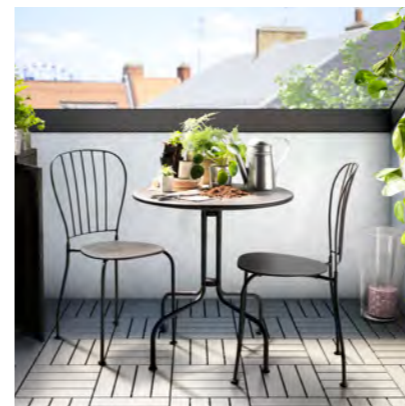

LÄCKÖ is inspired by traditional wrought-iron garden furniture. Made of powder-coated steel or plastic rattan, all pieces are maintenance-free and easy to care for.



FEJAN is a space-saving dream with pieces that stack or fold. Durable and maintenance-free, it is made of powder-coated steel and plastic that's slatted for a wooden look.



TORPARÖ dining set comes in different sizes — choose to use it on a small city balcony or a large villa terrace. Durable, maintenance-free materials allow you to get the most out of your outdoor life!

The story of BONDHOLMEN

A tribute to handicraft and common sense

How can we make your life at home more comfortable with knowledge of how people lived in the past? One way is to look at traditional handicraft and historic everyday objects. Like designer duo Tina Christensen and Kai Legaard when they created BONDHOLMEN outdoor furniture.

Frilandsmuseet is an open-air museum in the northern outskirts of Copenhagen. Here Tina and Kai take regularly strolls to see how the average Scandinavian lived before there were Internet and mobile phones. "The museum is a treasure. There are houses and furniture from times when everything was created from a need and had a purpose. It's very inspiring," says Tina.

Timeless

In the old days, people had the same need as we do today; to work, relax and come together. BONDHOLMEN has generous proportions that make it comfortable to do that for a long time. "We wanted to make it easy to spend time in BONDHOLMEN. Eat, play games, reply to emails, have a cold drink or just talk. Whatever you want to do when you're in your outdoor space."

Function is in the details

Tina mentions that past generations had a particularly good eye for function; every detail was there for a reason.

"People were also very careful with the materials they had, and didn't use more than they needed. Back then, it was called common sense. Today it is a way of being sustainable."

In the BONDHOLMEN series the legs are angled for steadiness, the seats have a small edge in the back to keep cushions in place and the furniture is easy to put away when the outdoor season ends. Every piece of furniture is made of sustainably sourced and high-quality eucalyptus wood. It's details that make the modern outdoor life a little easier and more sustainable. For Tina and Kai it's also a tribute to old handicraft and common sense.



Kai Legaard and Tina Christensen, the designer duo of BONDHOLMEN



Kai Legaard in his workshop studio where ideas from drawing boards are also tried out.

Behind the scenes

Get a glimpse into the designer process and production of BONDHOLMEN.



Being careful and attentive in each step of the production line of BONDHOLMEN.



Testing strength and durability so you can relax and feel confident when using your BONDHOLMEN.





Many of our outdoor furniture pieces are made of maintenance-free materials; these are marked with an easy-care symbol. To read more about how to take care of your outdoor furniture, see pg. 116.

2-seat dining sets



TÄRNÖ
Table L21½×W21×H27½", foldable. Chairs, foldable. Solid acacia and powder-coated steel. Requires assembly. Black/gray-brown stained 698.984.15



TÄRNÖ
Table L21½×W21×H27½", foldable. Chairs, foldable. Solid acacia and powder-coated steel. Requires assembly. Dark green/light brown stained 793.124.09



ÄPPLARÖ
Gate leg table, L13¾/32¾/51¾×W27½×H28¾". Chairs, foldable. Solid acacia. Requires assembly. Brown stained 593.265.39



SJÄLLAND
Table L28×W28×H28¾". Armchairs, stackable. Powder-coated aluminum. Requires assembly. Dark gray/light gray 592.649.42



SJÄLLAND
Table L28×W28×H28¾". Armchairs, stackable. Solid eucalyptus and powder-coated aluminum. Requires assembly. Light brown/light gray 592.649.04



New

SUNDSÖ
Table Ø25", H28", foldable. Chairs, foldable. Perfect for your balcony or other smaller spaces since it can be easily folded and put away. Comes pre-assembled. Powder-coated steel. Gray/gray. 294.349.22



LÄCKÖ
Table Ø27½", H28". Chairs, stackable. Powder-coated steel. Requires assembly. Gray 498.984.35



LÄCKÖ/VIHOLMEN
Table Ø27½", H28". Chairs, stackable. Powder-coated steel. Requires assembly. Gray. 194.135.24



TORPARÖ
Table, foldable L27½". Chairs, foldable. Powder-coated steel. White/beige 294.136.65



To protect your dining set from dirt, sun, rain, dust and pollen when not in use, we recommend you use TOSTERÖ waterproof cover.

TOSTERÖ Cover for furniture set Fits outdoor dining sets with a table and two chairs. 100% polyester. Imported. L39¾×W27½×H35¾".

Black 903.050.73



4-seat dining sets



ASKHOLMEN
Table L44½×W24¾×H28¾", foldable.
Chairs, foldable. Solid acacia. Requires assembly. Light brown stained 192.121.82



ASKHOLMEN
Table L13¾-32¾-51¾×W27½×H28¾", foldable.
Chairs, foldable. Solid acacia. Requires assembly. Light brown stained 993.254.58



BONDHOLMEN
Table, Ø42½". Solid eucalyptus. Requires assembly. Gray stained 293.304.82



TORPARÖ
Table L51¾×W29½", foldable. Armchair.
Powder-coated steel. Requires assembly. White/beige 694.136.68



TORPARÖ
Table L51¾×W29½", foldable. Reclining chair, foldable. Powder-coated steel. Requires assembly. White/beige 094.136.71



FALHOLMEN
Table L60¼×W28¾×H28¾".
Armchairs, stackable. Solid acacia. Requires assembly. Gray-brown stained 192.178.58



SJÄLLAND
Table L61¼×W35¼×H28¾". Bench W53½".
Armchairs, stackable. Powder-coated aluminum. Requires assembly. Dark gray 992.523.72



New
VIHOLMEN/LÄCKÖ
Table L53¾×W29¼×H28¾". Armchairs, stackable. Requires assembly. Gray/gray, powder-coated steel. 394.783.88



BONDHOLMEN
Table Ø42½". Reclining chairs, foldable. Solid eucalyptus. Requires assembly. Gray stained 094.128.41



BONDHOLMEN
Bar table L45¾×W28¾×H41¾". Bar stools. Solid eucalyptus. Requires assembly. Gray stained 394.129.72



SJÄLLAND
Table L61¼×W35¼×H28¾". Bench W53½".
Armchairs, stackable. Solid eucalyptus and powder-coated aluminum. Requires assembly. Light brown/light gray 992.651.57



SJÄLLAND
Table L61¼×W35¼×H28¾". Armchairs, stackable. Powder-coated aluminum. Requires assembly. Dark gray/light gray 292.650.14



SJÄLLAND
Table L61¼×W35¼×H28¾" Armchairs, stackable. Solid eucalyptus and powder-coated aluminum. Requires assembly. Light brown/light gray 192.523.71



ÄPPLARÖ
Drop-leaf table L55¾/78¾/102¾×W30¾×H28¾".
Armchairs, stackable. Solid acacia. Requires assembly. Brown stained 990.483.95

To protect your dining set from dirt, sun, rain, dust and pollen when not in use, we recommend you use TOSTERÖ waterproof cover.

TOSTERÖ Cover for furniture set
L57¾×W57¾"×H47¼". Fits outdoor dining sets with a table and 4 chairs.

Black 302.923.23



6/8-seat dining sets



ÄPPLARÖ
Drop-leaf table L55½/78¾/102¾×W30¾×H28¾". Armchairs, stackable. Solid acacia. Requires assembly. Brown stained 398.984.74



ÄPPLARÖ
Table L55½×W55½×H28¾". Armchairs, stackable. Solid acacia. Requires assembly. Brown stained 992.898.13



ÄPPLARÖ
Drop-leaf table L55½/78¾/102¾×W30¾×H28¾". Reclining chairs, foldable. Solid acacia. Requires assembly. Brown stained 690.539.82



BONDHOLMEN
Table L92½×W35¾×H29¾". Armchairs, stackable. Solid eucalyptus. Gray stained 393.240.13



SJÄLLAND
Table L61¼×W35¼×H28¾". Armchairs, stackable. Powder-coated aluminum. Requires assembly. Dark gray/light gray 192.652.03



SJÄLLAND
Table L61¼×W35¼×H28¾". Armchairs, stackable. Solid eucalyptus and powder-coated aluminum. Requires assembly. Light brown/light gray 192.651.99



New

NORRMANSÖ/NORRMANSÖ
Table L86¾×W39¾×H29¾". Chairs, stackable. Solid acacia wood and powder-coated aluminum. Requires assembly. Acacia/beige acacia. 394.261.58



To protect your dining set from dirt, sun, rain, dust and pollen when not in use, we recommend you use TOSTERÖ waterproof cover.

TOSTERÖ Cover for furniture set Fits outdoor dining sets with a table and six chairs. 100% polyester. Imported. L84¾×W53¾×H41¾". Black 503.050.65



New

NORRMANSÖ/VASSHOLMEN
Table L86¾×W39¾×H29¾". Chairs handmade by skilled craftspeople, which makes each one unique. Solid acacia wood and powder-coated aluminum. Requires assembly. Acacia/black white. 094.352.15



TOSTERÖ Cover for furniture set Fits outdoor dining sets with a table and eight chairs. 100% polyester. Imported. L102¾×W58¼×H42½". Black 804.281.59



SJÄLLAND
Table + 4 armchairs
Solid eucalyptus and powder-coated aluminum. L61¼×W35¼×H28¾". 192.523.71



Dining chairs, stools and benches



TÄRNÖ Chair, foldable Solid acacia and powder-coated steel. Requires assembly. Seat: W15¾×D11×H17¾".
Black/light brown stained 900.954.28
Dark green/light brown stained 104.449.78



ASKHOLMEN Chair, foldable Solid acacia. Requires assembly. Seat: W14¾×D11¾×H18¾".
Light brown stained 502.400.31



ÄPPLARÖ Stool, foldable Solid acacia. Requires assembly. W15¾×D15×H16½".
Brown stained 202.049.25



SJÄLLAND Bench Powder-coated aluminum. Requires assembly. Seat: W50×D16½×H16¾".
Light gray/dark gray 704.017.06



SJÄLLAND Bench Solid eucalyptus and powder-coated aluminum. Requires assembly. Seat: W50×D16½×H16¾".
Light gray/light brown 504.019.86



KLÖVEN Armchair Solid eucalyptus. Requires assembly. Seat: W19¾×D19¾×H16¾".
Black-brown stained 504.455.51



ÄPPLARÖ Chair, foldable Solid acacia. Requires assembly. Seat: W15×D14¾×H17¾".
Brown stained 404.131.31



BONDHOLMEN Chair, foldable Solid eucalyptus. Requires assembly. Seat 13¾×13¾×16¾".
Gray stained 004.735.27



ÄPPLARÖ Armchair Can be stacked, which helps you save space. Solid acacia. Requires assembly. Seat: W19¼×D19¼×H16¾".
Brown stained 202.085.27



BONDHOLMEN Reclining chair Solid eucalyptus. Seat 19¼×18¾×16¾".
Gray stained 104.818.43



VASSHOLMEN Chair Powder-coated steel and plastic. Requires assembly. W22¾×D23¾×H36¼". Seat: W18¾×D18¾×H18¾".
Black/white 305.037.40



LÄCKÖ Armchair Powder-coated steel and plastic. W22½×D26¾×H30¾". Seat: W17¾×D17¾×H18¾".
Dark gray 604.633.04



SUNDSÖ Chair, foldable Powder-coated steel. D18¾×H33¾". Seat: D13¾×H18¾×W15".
Gray 905.033.51



BONDHOLMEN Bar stool with backrest Solid eucalyptus. Requires assembly. Seat 17¾×17¾×29¾".
Gray stained 804.690.22



ÄPPLARÖ Reclining chair, foldable Solid acacia. Requires assembly. Seat: W17¾×D18¾×H15¾".
Brown stained 702.085.39



FALHOLMEN Armchair Solid acacia. Can be stacked, which helps you save space. Requires assembly. Seat: W19¾×D16½×H16¾".
Light brown stained 503.130.94



FEJAN Chair, foldable Powder-coated steel and plastic. Seat: W15¾×D15¾×H17¾".
White 102.553.07



TORPARÖ Chair, foldable In/outdoor. Powder-coated steel and plastic. Seat: W15¾×D15¾×H18¾".
White/beige 204.246.30



ÄPPLARÖ Bench Seats two. Solid acacia. Requires assembly. W44¾×D16¾×H17¾".
Brown stained 102.051.81



ÄPPLARÖ Bench with backrest Solid acacia. Requires assembly. Seat: W45¼×D20½×H16¾".
Brown stained 802.085.29



BONDHOLMEN Bench with backrest Solid eucalyptus. Requires assembly. Seat 59½×19¾×16½".
Gray stained 204.206.32



NORRMANSÖ Chair Solid acacia and powder-coated steel. Can be stacked, which helps you save space. Requires assembly. Seat: W16¾×D15¾×H17¾".
Beige/acacia 405.110.80



TEGELÖN Chair Powder-coated steel and plastic. W22¾×D24×H32¾". Seat: W20½×D18¾×H17¾".
Dark gray/black 005.038.07



TORPARÖ Chair with armrests In/outdoor. Powder-coated steel and plastic. The chair takes up less space when not in use since it's stackable. Seat: W16½×D16¾×H18¾".
White/beige 904.207.61



BONDHOLMEN Armchair Solid eucalyptus. Requires assembly. Seat: W19¾×D21¼×H16¾".
Gray stained 804.206.29



SJÄLLAND Armchair Powder-coated aluminum. Can be stacked, which helps you save space. Requires assembly. Seat: W17¾×D18¾×H16¾".
Light gray/dark gray 103.865.01



SJÄLLAND Armchair Solid eucalyptus and powder-coated aluminum. Can be stacked, which helps you save space. Requires assembly. Seat: W17¾×D18¾×H16¾".
Light gray/light brown 703.865.03



Dining chairs, stools and benches



TORPARÖ Reclining chair Powder-coated steel and plastic. The chair comes pre-assembled, so you can start using it immediately. Seat: W17¾×D18½×H18½".
White/beige 604.613.43



VÄDDÖ Chair Powder-coated steel/galvanized steel and plastic. You can have several chairs on hand without taking up more room, as they are stackable. Requires assembly. Seat: W15¾×D18½×H18½".
White 802.671.37



HÖGSTEN Armchair Powder-coated steel and plastic. Requires assembly. Seat: W15×D18¾×H16½".
White 202.098.62



STACKHOLMEN Stool Solid acacia and plastic. Imported. Requires assembly. W18¾×D13¾×H16¾".
Light brown stained 204.114.25



VIHOLMEN Chair Powder-coated steel and plastic. You can have several chairs on hand without taking up more room, as they are stackable. Requires assembly. Seat: W15×D15×H17¾".
Dark gray 204.633.01



LÄCKÖ Chair Powder-coated steel. You can have several chairs on hand without taking up more room, as they are stackable. Seat: W14¾×D14¾×H17¾".
Gray 601.518.40



BONDHOLMEN Rocking chair Solid eucalyptus. Requires assembly. Seat: W17¾×D17½×H17½".
Gray stained 504.790.65



PÄRONHOLMEN Bench with backrest Solid acacia wood. Requires assembly. W43½×D27¾×H32¾".
Red 905.037.99

Dining cushions - how to choose

Dining chairs	FRÖSÖN/DUVHOLMEN Beige, dark gray, dark beige-green	JÄRPÖN/DUVHOLMEN Anthracite, white	KUDDARNA Beige, gray	BRÄMÖN Gray-beige,	KLÖSAN Blue
Cushions					
ÄPPLARÖ					
Chair, foldable	Ø13¾"	—	12¾×14½"	13¾×13"	Ø13¾"
Armchair	19¾×19¾"	19¾×19¾"	19¾×19¾"	—	—
Reclining chair, foldable	45¾×17¾"	45¾×17¾"	145¾×18½"	—	—
Bench with backrest	19¾×19¾"	19¾×19¾"	19¾×19¾"	—	—
SJÄLLAND					
Armchair	17¾×17¾"	17¾×17¾"	17¾×17¾"	—	17¾×17¾"
Bench	Ø13¾"	—	12¾×14½"	—	Ø13¾"
BONDHOLMEN					
Chair, foldable	17¾×17¾"	17¾×17¾"	17¾×17¾"	—	Ø13¾"
Armchair	19¾×19¾"	19¾×19¾"	19¾×19¾"	—	—
Bench with backrest	19¾×19¾"	19¾×19¾"	19¾×19¾"	—	—
Reclining chair	45¾×17¾"	45¾×17¾"	45¾×18½"	—	—
Bar stool with backrest	17¾×17¾"	17¾×17¾"	17¾×17¾"	—	17¾×17¾"
Rocking chair	17¾×17¾", 45¾×17¾"	17¾×17¾", 45¾×17¾"	17¾×17¾", 45¾×18½"	—	—
ASKHOLMEN					
Chair, foldable	Ø13¾"	—	12¾×14½"	13¾×13¾"	Ø13¾"
FALHOLMEN					
Armchair	17¾×17¾"	17¾×17¾"	17¾×17¾"	—	17¾×17¾"
TÄRNÖ					
Chair, foldable	Ø13¾"	—	12¾×14½"	13¾×13¾"	Ø13¾"
LÄCKÖ					
Chair	Ø13¾"	—	—	—	—
Armchair	—	17¾×17¾"	—	—	17¾×17¾"
SUNDSÖ					
Chair, foldable	Ø13¾"	—	—	—	Ø13¾"
KLÖVEN					
Armchair	19¾×19¾"	—	19¾×19¾"	—	—

To see all our comfort cushions see pg. 68.



Dining tables



TÄRNÖ Table, foldable Seats 2. Solid acacia and powder-coated steel. Requires assembly. L21½×W21¼×H27½".

Black/light brown stained 700.954.29
Dark green/light brown stained 504.449.81



ASKHOLMEN Table, foldable Seats 2. Solid acacia. Requires assembly. L24¾×W23¾×H28¾".

Light brown stained 602.400.35



ÄPPLARÖ Table Seats 4-8. The hole in the middle of the table top keeps your umbrella in place. Solid acacia. Requires assembly. L55½×W55½×H28¾".

Brown stained 704.197.87



SJÄLLAND Table Seats 2. Solid eucalyptus and powder-coated aluminum. Requires assembly. L28×W28×H28¾".

Light brown/light gray 992.624.32



BONDHOLMEN Bar table. Seats 4. Solid eucalyptus. Requires assembly. L45¾×W28¾×H41¾".

Gray stained 404.690.24



SJÄLLAND Table Seats 4-6. The hole in the middle of the table top keeps your umbrella in place. Powder-coated aluminum. Requires assembly. L61¼×W35¼×H28¾".

Dark gray/light gray 492.648.72



ASKHOLMEN Table, foldable Seats 4. Solid acacia. Requires assembly. L44¼×W24¾×H28¾".

Light brown stained 103.378.17



BONDHOLMEN Table Seats 4. Requires assembly. Ø42½, H29½". Solid eucalyptus.

Gray stained 904.205.77



BONDHOLMEN Console table Can be used as an extra storage area beside your outdoor dining table, behind your outdoor sofa, by a wall or used as a room divider. Requires assembly. 43¾×W18½×H29½". Solid eucalyptus.

Gray stained 304.206.17



New

NORMANSÖ Table Seats 4-6. Made for 6 people, but easily has room for more since the table does not have any legs at the corners. Every table is unique, with varying grain pattern and natural color shifts that are part of the charm of wood. Solid acacia wood. Requires assembly. L86¾×W39¾×H28¾".

Acacia 305.007.94



SJÄLLAND Table Seats 4-6. The hole in the middle of the table top keeps your umbrella in place. Solid eucalyptus and powder-coated aluminum. Requires assembly. L61¼×W35¼×H28¾".

Light brown/light gray 792.624.47



KLOVEN Table Solid eucalyptus. Requires assembly. Ø49¼, H29½".

Black-brown stained 504.276.46



ÄPPLARÖ Drop-leaf table Seats 4-8. The hole in the middle of the table top keeps your umbrella in place. Solid acacia. Requires assembly. L55½/78¾/102¾×W30¾×H28¾".

Brown stained 402.085.31



FALHOLMEN Table Seats 4. Solid acacia. Requires assembly. L60¼×W28¾×H28¾".

Light brown stained 903.130.92



SJÄLLAND Table Seats 2. Powder-coated aluminum. Requires assembly. L28×W28×H28¾".

Dark gray/light gray 292.624.35



New

SUNDSÖ Table Seats 2. The table comes pre-assembled, so you can start using it immediately. Perfect for your balcony or other small spaces as it can be folded up and put away. Ø25½" H28".

Gray 705.033.52



BONDHOLMEN Table Seats 6. Requires assembly. L92½×W35¾×H29½". The hole in the middle of the table top keeps your umbrella in place. Solid eucalyptus.

Gray stained 104.205.62



Dining tables



TORPARÖ Table, foldable The table folds flat to store in less space. The hole in the middle of the table top keeps your umbrella in place. Powder-coated steel. Requires assembly. L51½×W29½×H29½".

White 704.207.57



LÄCKÖ Table Seats 2-4. Powder-coated steel. Requires assembly. Ø27½", H28".

Gray 401.518.41



TORPARÖ Table, foldable The table folds flat to store in less space. Powder-coated steel. Requires assembly. L27½×W16½×H28¾".

White 604.207.48



VIHOLMEN Table. Seats 4-6. The hole in the middle of the table top keeps your umbrella in place. Powder-coated steel and plastic. Requires assembly. L53½×W29½×H28¾".

Dark gray 304.633.05



VIHOLMEN Table Seats 4–6. Powder-coated steel and plastic. Requires assembly. L53½×W29½×H28¾". Dark gray. 304.633.05



Children's outdoor furniture

Play all day

From hosting tea parties to racing airplanes, the outdoors are made for hours of doing, exploring, smiling and laughing. That's why we design and make easy-to-care-for outdoor furniture sized for children, too — from chairs, stools and tables to an easy chair, beanbag and picnic table. Most pieces are even created for indoor and outdoor use, and the plastic ones are lightweight so children can carry them without your help. Just clean them off and bring them back indoors when the outdoor fun is done!





MAMMUT Children's chair In/outdoor. Recommended for 3-6 years. Polypropylene plastic. Requires assembly. W15½×D14½×H26¾". Seat: D10¼×H11¾".

Blue	603.653.46
White	403.653.71
Red	403.653.66
Pink	803.823.21



MAMMUT Children's stool In/outdoor. Recommended for 3-6 years. Polypropylene plastic. Requires assembly. Ø11¼, W13¾×H11¾".

Yellow	203.823.24
Orange	503.653.61



MAMMUT Children's table In/outdoor. Recommended for 3-6 years. Polypropylene plastic. Requires assembly. L30¾×W21¾×H18¾".

White	503.651.77
Red	603.651.67



MAMMUT Children's table In/outdoor. Recommended for 3-6 years. Polypropylene plastic. Requires assembly. Ø33½, H18¾".

Blue	903.651.80
------	------------



UTTER Children's stool In/outdoor. Recommended for 3 years and older. Reinforced polypropylene plastic. Requires assembly. W11×D11×H10¾".

White	503.577.85
-------	------------



UTTER Children's series In/outdoor. Recommended for 3 years and older. Reinforced polypropylene plastic. Requires assembly. L22¾×W16½×H16¾".

White	603.577.37
-------	------------



RESÖ Children's picnic table Recommended for 3 years and older. Stained solid acacia. Requires assembly. L36¼×W35×H19¼".

Gray-brown stained	702.283.25
--------------------	------------

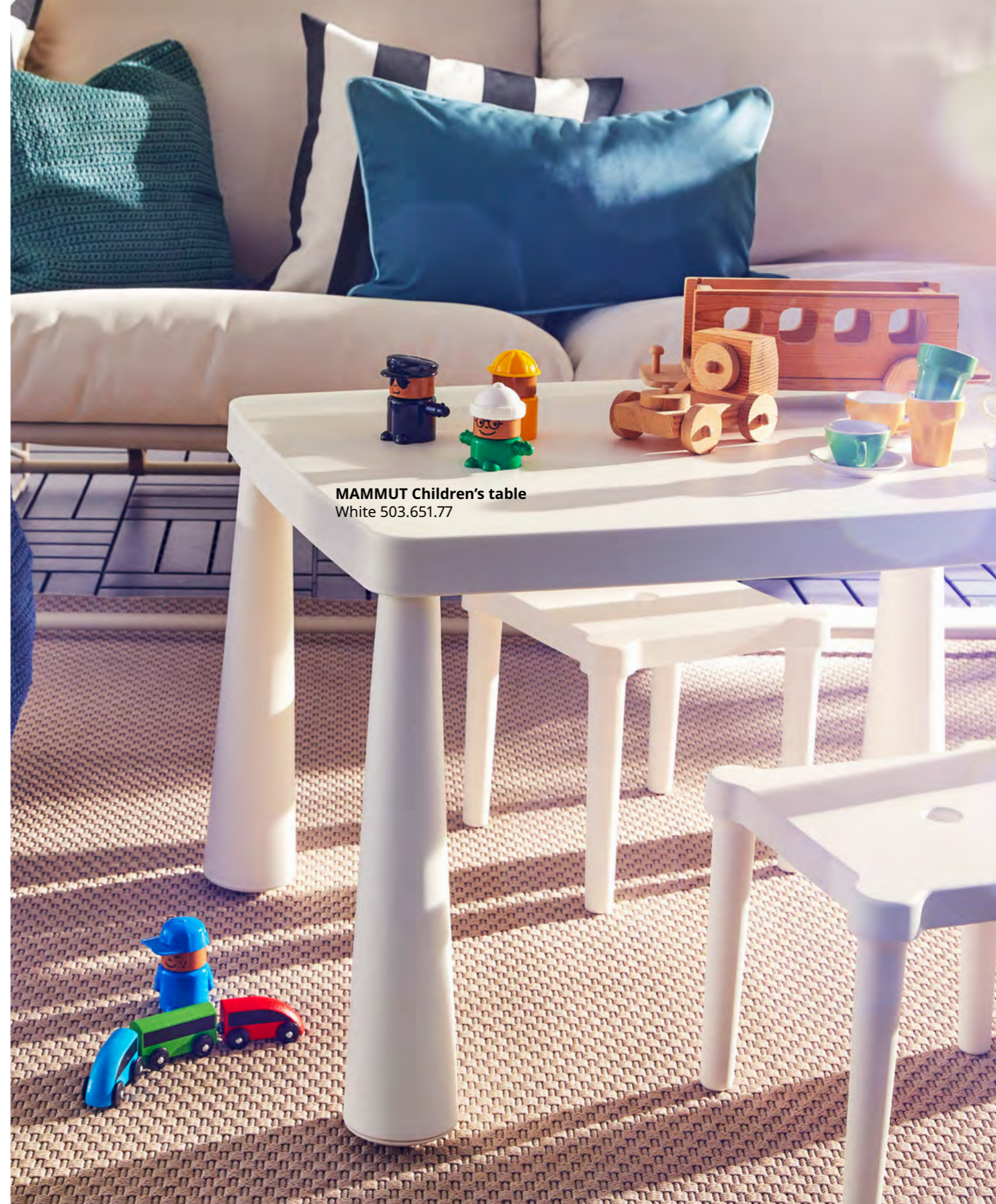

MAMMUT Children's table
White 503.651.77



Outdoor lounging and relaxing

Recharge your batteries

Picture your living room. Now imagine it outdoors. Whether that's a balcony, backyard or some sand at the beach, you can create a spot to chill out and recharge. With our wide variety of modular sofas and other seating, you'll find the right fit. For comfort, style and to really make your outdoor space feel like home, there are tables and cozy cushions. Before you get too comfy, just browse, dream and do!





Find your outdoor modular sofa style

How do you like to lounge? Are you a cozy snuggler on a loveseat? A lay-down, spread-out relaxer on a sprawling sofa with an ottoman? What size is your outdoor space? With a modular sofa, you can create a custom combination to suit your relaxation style and your lounging area. Plus, you can add sections later or easily disconnect and rearrange. We offer three series of fully modular outdoor sofas; SOLLERÖN, ÄPPLARÖ and JUTHOLMEN. With flexible HAVSTEN you can create an armchair, loveseat, 3-seat sofa or a sofa just as long as you like.



SOLLERÖN is made from easy-care, durable plastic rattan with same expression and feeling as natural rattan. Practical storage space under the seat. See more on pg. 42.



ÄPPLARÖ is made from durable solid acacia, a dark hardwood. Pre-treated with layers of stain, the wood needs a little care now and then for a long lifetime. See more on pg. 50.



HAVSTEN is flexible and durable with an airy frame of powder-coated steel tubes and plastic mesh seats. Easy to move, its comfy cushions and modern base are easy to care for, too. See more on pg. 56.



JUTHOLMEN is made of easy-care, durable plastic rattan and powder-coated steel with an airy weaving pattern in black-brown. See more on pg. 60.

SOLLERÖN modular sofa



SOLLERÖN is made from easy-care, durable plastic rattan with the same expression and feeling as natural rattan. Storage under the seat provides space for decorative cushions and throws.

Modular sofa sections



SOLLERÖN One-seat section Powder-coated steel and plastic. May be completed with JÄRPÖN/DUVHOLMEN, FRÖSÖN/DUVHOLMEN, or KUDDARNA back and seat cushions. Store away the decorative cushions and throws in the storage under the seat. May be completed with TOSTERÖ storage bag for cushions 24¾×24¾". Requires assembly. W24¾×D32¼×H29½". Seat: W24¾×D24¾×H12¾".

Brown 603.736.24



SOLLERÖN Corner section Powder-coated steel and plastic. May be completed with JÄRPÖN/DUVHOLMEN, FRÖSÖN/DUVHOLMEN or KUDDARNA back and seat cushions. Store away the decorative cushions and throws in the storage under the seat. May be completed with TOSTERÖ storage bag for cushions 24¾×24¾". Requires assembly. W32¼×D32¼×H29½". Seat: W24¾×D24¾×H12¾".

Brown 203.736.21



SOLLERÖN Stool Powder-coated steel and plastic. May be completed with JÄRPÖN/DUVHOLMEN, FRÖSÖN/DUVHOLMEN or KUDDARNA seat cushions. Store away the decorative cushions and throws in the storage under the seat. May be completed with TOSTERÖ storage bag for cushions 24¾×24¾". Requires assembly. L24¾×W24¾×H12¾".

Brown 403.736.15



SOLLERÖN Armrests Powder-coated steel and plastic. Requires assembly. W7¾×D32¼×H20¾".

Brown 103.864.50 2pk

Choose the solution that's right for you

You can combine SOLLERÖN sections into a modular sofa that perfectly suits your needs. If you want to make a different combination at a later time, it's easy to

disconnect the sections, rearrange and connect again in a whole new way. You can also select one of the ready-made combinations on the following pages.



SOLLERÖN modular sofa combinations

Loveseat with JÄRPÖN/DUVHOLMEN cushions



This combination Brown 393.262.34 with JÄRPÖN/DUVHOLMEN cushions, anthracite. Imported. Requires assembly. W63%×D32¼×H35%". Seat height 18½".



This combination Brown 693.262.37 with JÄRPÖN/DUVHOLMEN cushions, white. Imported. Requires assembly. W63%×D32¼×H35%". Seat height 18½".

Loveseat with KUDDARNA cushions



This combination Brown 493.032.13 with KUDDARNA cushions, beige. Imported. Requires assembly. W63%×D32¼×H35%". Seat height 18½".



This combination Brown 393.032.18 with KUDDARNA cushions, gray. Imported. Requires assembly. W63%×D32¼×H35%". Seat height 18½".

Loveseat with FRÖSÖN/DUVHOLMEN cushions



This combination Brown 892.523.77 with FRÖSÖN/DUVHOLMEN cushions, beige. Imported. Requires assembly. W63%×D32¼×H35%". Seat height 18½".



This combination Brown 892.525.08 with FRÖSÖN/DUVHOLMEN cushions, dark gray. Imported. Requires assembly. W63%×D32¼×H35%". Seat height 18½".



This combination Brown 194.137.17 with FRÖSÖN/DUVHOLMEN cushions, dark beige-green. Imported. Requires assembly. W63%×D32¼×H35%". Seat height 18½".



To protect your outdoor furniture from dirt, sun, rain, dust and pollen when not in use, we recommend you use TOSTERÖ waterproof cover.

TOSTERÖ Cover for outdoor furniture, W66%×D39%×H34¼". Fits outdoor loveseats with max. W67×D39×H34". 100% polyester and synthetic rubber. Imported. Requires assembly.

Black 504.279.29

SOLLERÖN modular sofa combinations

Corner sofa with JÄRPÖN/DUVHOLMEN cushions



This combination Brown 493.262.62 with JÄRPÖN/DUVHOLMEN cushions, anthracite. Imported. Requires assembly. W89/56¼×D32¼×H35¾". Seat height 18½".



This combination Brown 093.262.64 with JÄRPÖN/DUVHOLMEN cushions, white. Imported. Requires assembly. W89/56¼×D32¼×H35¾". Seat height 18½".

Corner sofa with KUDDARNA cushions



This combination Brown 493.032.46 with KUDDARNA cushions, beige. Imported. Requires assembly. W89/56¼×D32¼×H33¾". Seat height 15¾".



This combination Brown 493.032.51 with KUDDARNA cushions, gray. Imported. Requires assembly. W89/56¼×D32¼×H33¾". Seat height 15¾".

Corner sofa with FRÖSÖN/DUVHOLMEN cushions



This combination Brown 492.526.14 with FRÖSÖN/DUVHOLMEN cushions, beige. Imported. Requires assembly. W89/56¼×D32¼×H34¾". Seat height 17¾".



This combination Brown 592.526.61 with FRÖSÖN/DUVHOLMEN cushions, dark gray. Imported. Requires assembly. W89/56¼×D32¼×H34¾". Seat height 17¾".



This combination Brown 594.136.97 with FRÖSÖN/DUVHOLMEN cushions, dark beige-green. Imported. Requires assembly. W89/56¼×D32¼×H34¾". Seat height 17¾".



To protect your outdoor furniture from dirt, sun, rain, dust and pollen when not in use, we recommend you use TOSTERÖ waterproof cover.

TOSTERÖ Cover for outdoor furniture, L102¾×W65×H33½". Fits, for example, outdoor 3-seat corner sofa and a coffee table or outdoor 3-seat sofa together with an armchair and a coffee table with total max L102×W65×H34". 100% polyester and synthetic rubber. Imported. Requires assembly.

Black

704.114.99

SOLLERÖN modular sofa combinations

Sofa with ottoman with JÄRPÖN/DUVHOLMEN cushions



This combination Brown 993.262.69 with JÄRPÖN/DUVHOLMEN cushions, anthracite. Imported. Requires assembly. W87¾×D56¾×H35¾". Seat height 18¾".



This combination Brown 393.262.67 with JÄRPÖN/DUVHOLMEN cushions, white. Imported. Requires assembly. W87¾×D56¾×H35¾". Seat height 18¾".

Sofa with ottoman with KUDDARNA cushions



This combination Brown 193.032.62 with KUDDARNA cushions, beige. Imported. Requires assembly. W87¾×D56¾×H33¾". Seat height 15¾".



This combination Brown 093.032.67 with KUDDARNA cushions, gray. Imported. Requires assembly. W87¾×D56¾×H33¾". Seat height 15¾".

Sofa with ottoman with FRÖSÖN/DUVHOLMEN cushions



This combination Brown 092.526.87 with FRÖSÖN/DUVHOLMEN cushions, beige. Imported. Requires assembly. W87¾×D56¾×H34¾". Seat height 17¾".



This combination Brown 592.527.03 with FRÖSÖN/DUVHOLMEN cushions, dark gray. Imported. Requires assembly. W87¾×D56¾×H34¾". Seat height 17¾".



This combination Brown 394.137.21 with FRÖSÖN/DUVHOLMEN cushions, dark beige-green. Imported. Requires assembly. W87¾×D56¾×H34¾". Seat height 17¾".



To protect your outdoor furniture from dirt, sun, rain, dust and pollen when not in use, we recommend you to use TOSTERÖ waterproof cover.

TOSTERÖ Cover for outdoor furniture, L102¾×W65×H33½". Fits, for example, outdoor corner sofa and a coffee table or outdoor sofa together with an armchair and a coffee table with total max L102×W65×H33½". 100% polyester and synthetic rubber. Imported. Requires assembly.

Black

704.114.99

ÄPPLARÖ modular sofa



ÄPPLARÖ is made from sustainably sourced solid acacia, a dark hardwood. Acacia is a naturally durable and sturdy hardwood for outdoor use because of the high density of its wood fibers. For maximum protection it's pre-treated with wood stain. By restaining now and then you can enjoy it for many years.

Modular sofa sections



ÄPPLARÖ One-seat section Solid acacia. May be completed with KUDDARNA, FRÖSÖN/DUVHOLMEN or JÄRPÖN/DUVHOLMEN back and seat cushions. Requires assembly. W24¾×D31½×H28¾". Seat: W24¾×D24¾×H11".
Brown stained 602.051.88



ÄPPLARÖ Corner section Solid acacia. May be completed with KUDDARNA, FRÖSÖN/DUVHOLMEN or JÄRPÖN/DUVHOLMEN back and seat cushions. Requires assembly. W31½×D31½×H28¾". Seat: W24¾×D24¾×H11".
Brown stained 502.051.79



ÄPPLARÖ Table/stool section Solid acacia. May be completed with KUDDARNA, FRÖSÖN/DUVHOLMEN or JÄRPÖN/DUVHOLMEN seat cushions. Requires assembly. W24¾×L24¾×H11".
Brown stained 802.134.46



ÄPPLARÖ Armchair Solid acacia. May be completed with KUDDARNA, FRÖSÖN/DUVHOLMEN or JÄRPÖN/DUVHOLMEN back and seat cushions. Requires assembly. W33¾×D31½×H28¾". Seat: W24¾×D24¾×H11".
Brown stained 604.690.56

Choose the solution that's right for you

For a custom creation, find the look you like and combine the sofa sections to suit your wants and needs. Or choose from different 2-seat, 3-seat and corner combinations we've already picked out and planned. The choice is yours!



ÄPPLARÖ modular sofa combinations

Loveseat with KUDDARNA cushions



This combination 493.037.17 with KUDDARNA cushions, beige. Imported. Requires assembly. W63xD31½×H31½". Seat height 14½".



This combination 193.037.28 with KUDDARNA cushions, gray. Imported. Requires assembly. W63xD31½×H31½". Seat height 14½".

Lovseat with FRÖSÖN/DUVHOLMEN cushions



This combination 192.599.14 with FRÖSÖN/DUVHOLMEN cushions, beige. Imported. Requires assembly. W63xD31½×H33¾". Seat height 15¾".



This combination 892.600.61 with FRÖSÖN/DUVHOLMEN cushions, dark gray. Imported. Requires assembly. W63xD31½×H33¾". Seat height 15¾".



This combination 394.138.58 with FRÖSÖN/DUVHOLMEN cushions, dark beige-green. Imported. Requires assembly. W63xD31½×H33¾". Seat height 15¾".

Loveseat with JÄRPÖN/DUVHOLMEN cushions



This combination 793.052.96 with JÄRPÖN/DUVHOLMEN cushions, anthracite. Imported. Requires assembly. W63xD31½×H33¾". Seat height 16½".



This combination 293.052.89 with JÄRPÖN/DUVHOLMEN cushions, white. Imported. Requires assembly. W63xD31½×H33¾". Seat height 16½".

Sofa with ottoman with KUDDARNA cushions



This combination 593.037.74 with KUDDARNA cushions, beige. Imported. Requires assembly. W87¾/56¼×D31½×H31½". Seat height 14½".



This combination 493.037.79 with KUDDARNA cushions, gray. Imported. Requires assembly. W87¾/56¼×D31½×H31½". Seat height 14½".

Sofa with ottoman with FRÖSÖN/DUVHOLMEN cushions



This combination 192.673.39 with FRÖSÖN/DUVHOLMEN cushions, beige. Imported. Requires assembly. W87¾/56¼×D31½×H33¾". Seat height 15¾".



This combination 692.620.37 with FRÖSÖN/DUVHOLMEN cushions, dark gray. Imported. Requires assembly. W87¾/56¼×D31½×H33¾". Seat height 15¾".



This combination 894.138.70 with FRÖSÖN/DUVHOLMEN cushions, dark beige-green. Imported. Requires assembly. W87¾/56¼×D31½×H33¾". Seat height 15¾".

Sofa with ottoman with JÄRPÖN/DUVHOLMEN cushions



This combination 393.053.64 with JÄRPÖN/DUVHOLMEN cushions, anthracite. Imported. Requires assembly. W87¾/56¼×D31½×H33¾". Seat height 16½".



This combination 693.053.53 with JÄRPÖN/DUVHOLMEN cushions, white. Imported. Requires assembly. W87¾/56¼×D31½×H33¾". Seat height 16½".

ÄPPLARÖ modular sofa combinations

Corner sofa with KUDDARNA cushions



This combination 193.038.32 with KUDDARNA cushions, beige. Imported. Requires assembly. W87¾/56¼×D31½×H31½". Seat height 14¼".



This combination 293.038.41 with KUDDARNA cushions, gray. Imported. Requires assembly. W87¾/56¼×D31½×H31½". Seat height 14¼".

Corner sofa with FRÖSÖN/DUVHOLMEN cushions



This combination 592.621.51 with FRÖSÖN/DUVHOLMEN cushions, beige. Imported. Requires assembly. W87¾/56¼×D31½×H33¾". Seat height 15¾".



This combination 992.621.73 with FRÖSÖN/DUVHOLMEN cushions, dark gray. Imported. Requires assembly. W87¾/56¼×D31½×H33¾". Seat height 15¾".



This combination 694.138.66 with FRÖSÖN/DUVHOLMEN cushions, dark beige-green. Imported. Requires assembly. W87¾/56¼×D31½×H33¾". Seat height 15¾".

Corner sofa with JÄRPÖN/DUVHOLMEN cushions



This combination 993.053.42 with JÄRPÖN/DUVHOLMEN cushions, anthracite. Imported. Requires assembly. W87¾/56¼×D31½×H33¾". Seat height 16½".



This combination 693.053.29 with JÄRPÖN/DUVHOLMEN cushions, white. Imported. Requires assembly. W87¾/56¼×D31½×H33¾". Seat height 16½".



To protect your outdoor furniture from dirt, sun, rain, dust and pollen when not in use, we recommend you use TOSTERÖ waterproof cover.

TOSTERÖ Cover for outdoor furniture, W66¾×D39¾×H34¼". Fits outdoor loveseats with max W67×D39×H34". 100% polyester and synthetic rubber. Imported.

Black

504.279.29



TOSTERÖ Cover for outdoor furniture, L102¾×W65×H33½". Fits, for example, outdoor 3-seat corner sofa and a coffee table or outdoor 3-seat sofa together with an armchair and a coffee table with total max L102×W65×H33½". 100% polyester and synthetic rubber. Imported.

Black

704.114.99

HAVSTEN sofa



HAVSTEN is flexible and durable with an airy frame of powder-coated steel tubes and plastic mesh seats. Easy to move, its comfy cushions and modern base are easy to care for, too.

Hang out your way with flexible HAVSTEN

HAVSTEN sofa is comfortable, durable and flexible to suit you — and what you love to do. It's easy to move around thanks to its airy frame made of lightweight, sturdy powder-coated steel tubes. And it's easy to lounge in and care for because its plastic mesh seats are topped with fluffy cushions that resist sunlight and light rain. Whether an outdoor armchair is all you need or you want bigger than a 4-seat sofa, you can make it happen with HAVSTEN.

To make HAVSTEN really flexible, we completely separated its parts. But that makes it a little bit different. Although you build HAVSTEN based on sections, each one-seat section consists of parts you buy and pick separately. The seat and back are one part. The armrest sides are one part. As you add on one-seat sections, you will need supporting stands. One thing's the same. We've still made it as easy as possible to buy with our ready-made combinations. If you want bigger than a 4-seat sofa, look for add-on units.

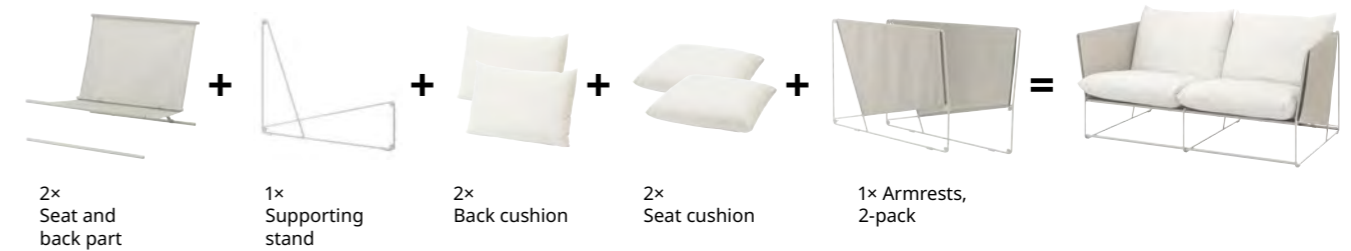

Winner of the Red Dot Award 2017

HAVSTEN sofa has been awarded one of the world's finest design awards — Red Dot Design Award — in the category for product design. The prized sofa was designed to be truly flexible — easy to move around and use to furnish in different ways. It's made in powder-coated steel with fluffy, comfortable cushions that resist both broiling sunlight and light rain, and has detachable parts and materials so you can create your own favorite sofa under the open skies.



HAVSTEN Sofa combinations



Armchair 100% polyester cover. Powder-coated, galvanized steel. Imported. Requires assembly. W38%×D37×H35%. Seat height 16½". Seat depth 24%. Beige 592.519.30



Loveseat 100% polyester cover. Powder-coated, galvanized steel. Imported. Requires assembly. W70½×D37×H35%. Seat height 16½". Seat depth 24%. Beige 292.519.60



Loveseat without armrests 100% polyester cover. Powder-coated, galvanized steel. Imported. Requires assembly. W64%×D37×H35%. Seat height 16½". Seat depth 24%. Beige 192.519.65



Sofa 100% polyester cover. Powder-coated, galvanized steel. Imported. Requires assembly. W102%×D37×H35%. Seat height 16½". Seat depth 24%. Beige 192.519.70



Sofa without armrests 100% polyester cover. Powder-coated, galvanized steel. Imported. Requires assembly. W96½×D37×H35%. Seat height 16½". Seat depth 24%. Beige 592.519.87



4-seat sofa 100% polyester cover. Powder-coated, galvanized steel. Imported. Requires assembly. W134%×D37×H35%. Seat height 16½". Seat depth 24%. Beige 492.520.82



4-seat sofa without armrests 100% polyester cover. Powder-coated, galvanized steel. Imported. Requires assembly. W128%×D37×H35%. Seat height 16½". Seat depth 24%. Beige 692.672.90



Add-on unit You can easily make your HAVSTEN sofa longer with this add-on unit. 100% polyester cover. Powder-coated, galvanized steel. Imported. Requires assembly. W32%×D37×H35%. Seat height 16½". Seat depth 24%. Beige 292.519.98

To protect your outdoor furniture from dirt, sun, rain, dust and pollen when not in use, we recommend you use TOSTERÖ waterproof cover.



TOSTERÖ Cover for outdoor furniture Fits outdoor armchairs and easy chairs with max W42%×max D33½×max H35%. 100% polyester and synthetic rubber. Imported.
Black 304.279.25



TOSTERÖ Cover for outdoor furniture Fits outdoor loveseat with max W66%×max D39%×max H34¼". 100% polyester and synthetic rubber. Imported.
Black 504.279.29



TOSTERÖ Cover for outdoor furniture Fits outdoor sofa together with an armchair and a coffee table with total max W102×max D65×max H33½". 100% polyester and synthetic rubber. Imported.
Black 704.114.99



HAVSTEN
Armchair. W38%×D37×H35%.
Beige 592.519.30

JUTHOLMEN modular sofa

Modular sofa sections



JUTHOLMEN Corner section. May be completed with KUDDARNA, FRÖSÖN/DUVHOLMEN or JÄRPÖN/DUVHOLMEN back and seat cushions. Powder-coated steel and plastic. Requires assembly. W28¾×D28¾×H28". Seat: W25¾×D25¾×H12¼".

Dark gray 804.691.16



JUTHOLMEN One-seat section. May be completed with KUDDARNA, FRÖSÖN/DUVHOLMEN or JÄRPÖN/DUVHOLMEN back and seat cushions. Powder-coated steel and plastic. Requires assembly. W25¼×D29¼×H28". Seat: W25¼×D25¼×H12¼".

Dark gray 404.521.89



JUTHOLMEN Stool. May be completed with KUDDARNA, FRÖSÖN/DUVHOLMEN or JÄRPÖN/DUVHOLMEN seat cushions. Powder-coated steel and plastic. Requires assembly. L25¾×W25¾×H12¼".

Dark gray 004.691.15



Choose the solution that's right for you

You can combine JUTHOLMEN sections into a modular sofa that perfectly suits your needs. If you want to make a different combination at a later time, it's easy to

disconnect the sections and reconfigure them in a whole new way. You can also choose one of the pre-made combinations on the following page.



Loveseat with KUDDARNA cushions



This combination 894.227.99 with KUDDARNA seat and back cushions, beige. W57½×D28¾×H32¾". Seat height 15¾".



This combination 094.227.98 with KUDDARNA seat cushions, beige. W57½×D28¾×H28". Seat height 15¾".

Sofa with ottoman KUDDARNA cushions



This combination 894.228.03 with KUDDARNA seat and back cushions, beige. W54¾/82¾×D28¾×H28". Seat height 15¾".



This combination 094.228.02 with KUDDARNA seat cushions, beige. W54¾/82¾×D28¾×H28". Seat height 15¾".

Corner sofa with KUDDARNA cushions



This combination 694.227.95 with KUDDARNA seat and back cushions, beige. W57½/79½×D28¾×H28". Seat height 15¾".



This combination 994.227.94 with KUDDARNA seat cushions, beige. W57½/79½×D28¾×H28". Seat height 15¾".

Outdoor armchairs, sofas and tables

Lounge with ease

Why limit your living space? You can easily create a lounge-worthy hangout outdoors, too. Start with seating like modular or solitary sofas and armchairs. Add in a coffee table or a side table, so you (and your guests) have a place to set down food and drinks. Then take a break from indoor life and take that book, board game, smart phone or snack into the great outdoors.



Armchairs and sofas



BONDHOLMEN Armchair Stained, solid eucalyptus wood. May be completed with JÄRPÖN/DUVHOLMEN, FRÖSÖN/DUVHOLMEN or KUDDARNA seat and back cushions. Requires assembly. W30¾×D31¾×H28¾". Seat: W24¾×D24¾×H11¾".
Gray stained 304.206.60



BONDHOLMEN Loveseat Stained, solid eucalyptus wood. May be completed with JÄRPÖN/DUVHOLMEN, FRÖSÖN/DUVHOLMEN or KUDDARNA seat and back cushions. Requires assembly. W54¾×D31¾×H28¾". Seat: W48¾×D24¾×H11¾".
Gray stained 704.206.63



KLÖVEN Armchair Solid eucalyptus. May be completed with JÄRPÖN/DUVHOLMEN, FRÖSÖN/DUVHOLMEN or KUDDARNA seat and back cushions. Requires assembly. W29¾×D31¾×H28¾". Seat: W24¾×D23¾×H13".
Black-brown 103.125.53



KLÖVEN Loveseat Solid eucalyptus. May be completed with JÄRPÖN/DUVHOLMEN, FRÖSÖN/DUVHOLMEN or KUDDARNA seat and back cushions. Requires assembly. W54¾×D31¾×H28¾". Seat: W48¾×D23¾×H13".
Black-brown stained 903.125.49



HÖGSTEN Armchair Powder-coated steel and plastic. Requires assembly. W29¾×D30¾×H36¾". Seat: W17¾×D19¾×H13".
White 502.098.65



GUBBÖN Rocking chair, in/outdoor. Powder-coated steel and plastic. Requires assembly. W29¾×D37¾×H40½". Seat: W22×D18¾×H20¾".
White 004.690.35



BRUSEN Sofa Powder-coated steel. May be completed with JÄRPÖN/DUVHOLMEN, FRÖSÖN/DUVHOLMEN or KUDDARNA chair cushion (20×20"). Requires assembly. W57½×D25¼×H29½". Seat: W47¼×D20½×H16½".
Red 704.241.47



HUSARÖ Armchair Powder-coated galvanized steel, polyester/TPE and plastic. Requires assembly. W25¼×D31¾×H40¾". Seat: W22½×D18¾×H16½".
Dark gray 004.107.47



HÖGSTEN Loveseat Powder-coated steel and plastic. Requires assembly. W57½×D25¼×H29½". Seat: W47¼×D20½×H13¾".
White 505.125.93



VINGSÖN Wing chair with cushion Solid acacia and powder-coated steel. Requires assembly. W41×D34¼×H56¾". Seat: W24¾×D24¾×H12¼".
Gray 705.037.38



RISHOLMEN Wing chair Powder-coated steel and plastic. Requires assembly. W26¾×D26¾×H31½". Seat: W19¾×D19¾×H14¾".
Brown 005.037.94

Coffee tables and side tables



BONDHOLMEN Coffee table Solid eucalyptus. Requires assembly. L43¾×W23¾×H18½".

Gray stained 604.206.73



BONDHOLMEN Console table Solid eucalyptus. Requires assembly. L43¾×W18½×H29½".

Gray stained 304.206.17



KLÖVEN Coffee table Solid eucalyptus. Requires assembly. L44½×W26×H16½".

Black-brown stained 703.125.50



ÄPPLARÖ Table/stool section Solid acacia. Requires assembly. L24¾×W24¾×H11".

Brown stained 802.134.46



ÄPPLARÖ Coffee table Solid acacia. Requires assembly. L35¾×W21¾×H17¾".

Brown stained 904.246.03



SOLLERÖN Coffee table Powder-coated steel, aluminum and plastic. Requires assembly. L36¼×W24¾×H20½".

Anthracite/brown 803.736.18



KROKHOLMEN Coffee table Powder-coated steel/galvanized steel and plastic. Requires assembly. Ø28¾, H17¾".

Beige 803.364.66



HUSARÖ Side table Powder-coated steel/galvanized steel and plastic. Requires assembly. L19¼×W19¼×H20½". Height including handle 28¾".

Dark gray 704.107.44



KROKHOLMEN
Coffee table. Ø28¾, H17¾".
Beige. 803.364.66



Outdoor chaises, beach chairs, hammocks and more

Relax your way

Meditating under a shady tree or bronzing poolside with a frozen treat — relaxation is personal. That's why we offer lots of laid-back options to help you unwind like chaises, beach chairs and easy chairs. For ultimate alone time, we even have hammocks. There's a hammock stand, too, so you can hang loose until you plant those beachfront palm trees. However you're taking a break, don't forget a straw hat. Yep, we've even got that!



Chaises, beach chairs, and more



ÄPPLARÖ Chaise Solid acacia. Requires assembly. L78¾×W28×H13".

Brown stained 902.085.43



SKARPÖ Armchair, outdoor Polypropylene plastic (min. 20% recycled). W31¾×D31¾×H28". Seat: W20¾×D19¼×H14¾".

White 702.341.85
Dark beige 804.530.78



FREDÖN Hammock 100% polyester, solid eucalyptus and plastic. Max. load 265 lbs. May be completed with GÄRÖ hammock stand. Requires assembly. L78¾×W39¾".

Beige 804.687.15



New

HAMNÖN Hammock 100% polyester. Max. load 265 lbs. May be completed with GÄRÖ hammock stand. Requires assembly. 59×104¾".

Red/white 705.027.86



GÄRÖ Hammock stand. L118½×W46¾×H50¾". Powder-coated steel and plastic. Max. load 264 lbs.

Gray 802.515.13



Outdoor comfort cushions

Stay a while

Make yourself comfortable for long naps and even longer meals with our thick, padded cushions. In a variety of colors, they add an extra splash of style to your outdoor seating. Many have fade-resistant color — thanks to how they're dyed — and are water-repellent, so you can shake off the water after a light, passing rain shower. Many of them have longer lives because you can flip and use both sides. Their ties and/or straps keep the chair cushions and pads firmly in place on the chair, too. And many cushions have removable, machine-washable covers for easy cleaning of melted ice cream.



JÄRPÖN/DUVHOLMEN and FRÖSÖN/DUVHOLMEN

Both the cushion covers of **FRÖSÖN** and the cushion family **JÄRPÖN** are sold separately from **DUVHOLMEN** inner cushions. Why? To make life better, of course! You can change up your outdoor look just by changing the cover. It'll take some time for its color to fade, because we dye the yarn in a way that makes color last longer (and uses less water). You won't slide around on your seat either, thanks to the fact that most of the **FRÖSÖN** covers have straps that keep the cushions in place and **JÄRPÖN** covers have anti-slip dots on the underside.

You can shake off water from a light rain, because **both** **JÄRPÖN** and **FRÖSÖN** are water repellent without the use of perfluorinated chemicals. If the cover's dirty, just wash it in the machine. And you can relax even more knowing that we make the cover fabric from a minimum of 90% recycled polyester, which reduces the use of new raw materials and lowers its environmental footprint.

In addition, **JÄRPÖN** cushion covers have a piping that makes them different in design. Each cover also has a padded inlay that increases your seating comfort.

JÄRPÖN/DUVHOLMEN

JÄRPÖN cushion covers: 100% polyester. Underside: Polyester, synthetic rubber. **DUVHOLMEN** inner cushions: Filling; polyester wadding/polyurethane foam. Do not wash. All textiles shown are imported.



JÄRPÖN Cover for chair pad To be completed with **DUVHOLMEN** inner cushion for chair pad. 19%×19%".

Anthracite	104.453.17
White	404.453.06



JÄRPÖN Cover for seat pad To be completed with **DUVHOLMEN** inner cushion for seat cushion. 24%×24%".

Anthracite	204.453.31
White	104.453.22



JÄRPÖN Cover for back cushion To be completed with **DUVHOLMEN** inner cushion for back cushion. 24%×17%".

Anthracite	504.453.01
White	604.452.92



DUVHOLMEN Inner cushion for chair cushion 19%×19%". Thickness 2".

White	804.178.96
-------	------------



DUVHOLMEN Inner cushion for seat cushion 24%×24%". Thickness 4%".

White	403.918.55
-------	------------



DUVHOLMEN Inner cushion for back cushion 24%×17%". Thickness 5½%".

White	003.918.38
-------	------------



JÄRPÖN Cover for seat/back cushion To be completed with **DUVHOLMEN** inner cushion for seat/back cushion. 45%×17%".

Anthracite	404.834.78
White	504.835.24



JÄRPÖN Cover for back cushion To be completed with **DUVHOLMEN** inner cushion for back cushion. 24%×17%".

Anthracite	504.453.01
White	604.452.92

FRÖSÖN/DUVHOLMEN

FRÖSÖN cushion covers: 100% polyester, machine washable. **DUVHOLMEN** inner cushions: Filling; polyester wadding/polyurethane foam. Do not wash. All textiles shown are imported.



FRÖSÖN Cover for chair pad To be completed with **DUVHOLMEN** inner cushion for chair pad. Ø13¾".

Beige	503.917.46
Dark gray	703.917.45
Dark beige-green	504.793.29



FRÖSÖN Cover for chair pad To be completed with **DUVHOLMEN** inner cushion for chair pad. 17%×17%".

Beige	303.917.47
Dark gray	103.917.48
Dark beige-green	704.793.33



FRÖSÖN Cover for chair pad To be completed with **DUVHOLMEN** inner cushion for chair pad. 19%×19%".

Beige	204.129.34
Dark gray	604.129.46
Dark beige-green	804.793.37



DUVHOLMEN Inner cushion for chair cushion Ø13¾". Thickness 1%".

White	003.918.43
-------	------------



DUVHOLMEN Inner cushion for chair cushion 17%×17%". Thickness 2".

White	703.918.49
-------	------------



DUVHOLMEN Inner cushion for chair cushion 19%×19%". Thickness 2".

White	804.178.96
-------	------------



FRÖSÖN Cover for seat/back pad To be completed with **DUVHOLMEN** inner cushion for seat/back pad. L45%×W17¾".

Beige	503.917.51
Dark gray	303.917.52
Dark beige-green	904.793.46

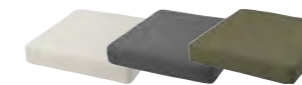

FRÖSÖN Cover for seat pad To be completed with **DUVHOLMEN** inner cushion for seat cushion. 24%×24%".

Beige	903.917.49
Dark gray	703.917.50
Dark beige-green	804.793.42

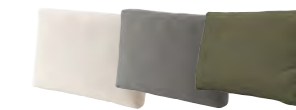

FRÖSÖN Cover for back pad To be completed with **DUVHOLMEN** inner cushion for back cushion. 24%×17%".

Beige	203.917.43
Dark gray	003.917.44
Dark beige-green	304.793.25



DUVHOLMEN Inner cushions for seat/back cushion Includes: one seat cushion (17¾×16½") and one back cushion (17¾×28"). Thickness 2".

White	203.918.61
-------	------------



DUVHOLMEN Inner cushion for seat cushion 24%×24%". Thickness 4%".

White	403.918.55
-------	------------



DUVHOLMEN Inner cushion for back cushion 24%×17%". Thickness 5½%".

White	003.918.38
-------	------------



FRÖSÖN Chaise cushion cover To be completed with **DUVHOLMEN** inner cushion for chaise pad. L75×W24".

Beige	005.098.85
Dark gray	105.099.03



DUVHOLMEN Inner cushion for chaise pad L74¾×W23¾". Thickness 2".

White	305.099.35
-------	------------

KUDDARNA

KUDDARNA chair cushions, seat/back cushions and back cushions add a traditional look to outdoor seating and have ties to stay firmly in place. They all have longer lives, since they can be turned over and used on both sides. Their fade-resistant fabric is dyed in a more sustainable way that also makes the color last longer in the sun, too.

This dyeing process reduces consumption of water and dye while improving color fastness compared to traditional dyeing techniques. The seat cushion has a removable, machine washable cover.

100% polyester cover. Polyurethane foam filling. Imported. Handwash.



KUDDARNA Chair pad 14½×12½". Thickness 2¾".

Beige	404.110.71
Gray	204.110.86



KUDDARNA Chair pad 17¾×17¾". Thickness 2¾".

Beige	204.110.91
Gray	604.111.07



KUDDARNA Chair pad 19¾×19¾". Thickness 2¾".

Beige	104.179.13
Gray	004.179.23



KUDDARNA Seat/back pad L45¾×W17¾". Seat depth 16½", back height 28¾". Thickness 2¾".

Beige	404.111.32
Gray	204.111.47

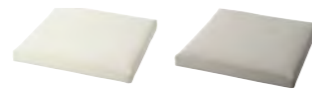

KUDDARNA Seat cushion Machine washable cover, do not wash inner cushion. 100% polyester cover. Non-woven polypropylene inner fabric. Polyester wadding/polyurethane foam filling. 24¾×24¾". Thickness: 3¾".

Beige	604.111.12
Gray	404.111.27



KUDDARNA Back cushion 24¾×17¾". Thickness: 2¾".

Beige	604.110.51
Gray	404.110.66



KUDDARNA Chaise pad 74¾×23¾". Thickness 2¾".

Beige	404.808.42
Gray	604.808.41

BRÄMÖN

BRÄMÖN Suitable for both indoor and outdoor use. The chair pad has two identical sides so it can be turned over for even wear.

100% polyester fabric. Polyurethane foam filling. Imported. Wash by hand.



BRÄMÖN Chair pad In/outdoor. 13¾×13".

Gray-beige	804.846.64
------------	------------

KLÖSAN

The cushion has a longer life, since it can be turned over and used on both sides. The fabric is made of recycled polyester. Using waste as a resource takes us one step closer

to a more sustainable future. 100% polyester cover (100% recycled). 100% hollow fiber polyester filling (100% recycled). Imported. Wash by hand, max 104°F.



KLÖSAN Chair pad Ø13¾". Thickness: 2¾".

Blue	005.157.06
------	------------



KLÖSAN Chair pad 17¾×17¾". Thickness: 2¾".

Blue	005.157.11
------	------------

Protective storage bags and boxes

To protect your outdoor cushions from sun, dirt, dust and pollen when not in use, we recommend to store them in a storage bag or storage box.



TOSTERÖ Storage bag for cushions Fits in ÄPPLARÖ storage bench L50¾×W22½". 100% polyester. Imported. L45¾×W19¼×H13¾".

Black	103.050.72
-------	------------



VRENEN Storage box W61¾×D28×H36¾".

Light gray/gray	504.114.43
-----------------	------------



TOSTERÖ Storage box 100% polyester and synthetic rubber. Imported. W50¾×D17¾×H31¾".

Black	304.114.39
-------	------------



Decorative cushions and throws

Enhance your style

Show off your personality and get just-right extra padding. Whether you're after a subtle touch of color, an impactful pop or an eye-catching pattern, we have plenty of outdoor decorative cushions to choose from. We design them for the outdoors, so most are fade resistant from a dope-dyeing process that's more friendly to the environment. And most are water repellent, too — just shake off the water after a light, passing rain shower. To keep them clean and protected when they're not in use, we recommend TOSTERÖ storage bags and storage box or VRENEN storage box.



In/outdoor cushions

These cushions are designed for the outdoors. So you can just shake off water from a light rain, as the cushion cover is water repellent. And the color stays

fresh for longer as the fabric is fade resistant. You can use them indoors as well.



TOFTÖ Cushion cover. The crochet cover is handmade by skilled craftspeople, which makes every cover unique. Machine washable. 100% polypropylene cover, 100% polyester lining. Imported. To be completed with INNER cushion pad 20×20", when used outdoors. 20×20".

Beige 805.157.69



GULLBERGSÖ Cushion cover Machine-washable. 100% polyester. Imported. To be completed with INNER cushion pad 20×20", when used outdoors. 20×20".

Red/dot pattern 605.098.73
Red/stripe 105.122.98



INNER Cushion pad White. Machine-washable. 100% polypropylene/polyester. Imported. 20×20" 702.621.97

16×26" 302.308.96

Note:

Inner cushions sold separately.

Indoor cushions

Although indoor cushions are not water repellent or fade resistant, you can still use them as lively outdoor additions — for a while. To keep them fresh and

colorful, it's important to bring them back inside when you're done having fun in the sun.



SOLMOTT Cushion cover Machine washable. 100% cotton. Imported. To be completed with INNER cushion pad 20×20".

Pink multicolor/stripe 505.127.91
Gray/stripe 405.139.27



STORTIMJAN Cushion cover Machine washable. 100% cotton. Imported. To be completed with INNER cushion pad 20×20".

Black/beige 505.022.59
Gray/white 905.069.67



EBBATILDA Cushion cover Machine washable. 100% cotton. Imported. To be completed with INNER cushion pad 20×20".

Gray-turquoise 004.930.16
Rust 104.929.50



PRAKTSALVIA Cushion cover Machine washable. 100% cotton. Imported. To be completed with INNER cushion pad 20×20". Other colors available, prices may vary.

Anthracite 305.115.75
Brown 905.106.05



GURLI Cushion cover Fits inner cushions 20×20". Machine washable. 100% cotton. Imported. 20×20". Other colors available, prices may vary.

Brown-yellow 004.791.81
Golden-yellow 203.958.21
Olive-green 204.747.00
Black 802.811.38
Gray 602.811.44



LYKTBÄRARE Cushion cover Machine washable. 100% cotton. Imported. To be completed with INNER cushion pad 20×20. 20×20".

Light beige/multicolor 705.106.06

Throws



INGABRITTA Throw Indoor. Machine washable. Acrylic/cotton material. Imported. W51×L67".

Off-white	903.522.72
Light gray	704.677.21
Pale pink	703.740.67
Yellow	804.951.63



INGRUN Throw Indoor. Machine washable. Acrylic/cotton material. Imported. W51×L67".

Gray	204.093.90
White	404.093.94
Dark green	104.927.33

How to mix and match with cushions

Want to make your outdoor sofa as cozy and stylish as your indoor sofa? Create a cushion combo! Here's one way to do it that's as easy as 1, 2, 3 with our range of

in/outdoor cushions. They're designed to coordinate, so it's simple to group them together.

1. Start by choosing a base of comfort seat and back cushions in your favorite neutral color. These are thick, padded, bigger cushions with covers like FRÖSON on pg. 71.
2. Add a solid color or two.
3. Pick a pattern like stripes, buttons or abstracts. Look for decorative cushions like GULLBERGSÖ or others on the facing page. Now take a seat and relax!



Helpful hints:

We're talking mainly covers here. You'll need the corresponding inner cushions or pads, too. If you're feeling adventurous or fall in love with a pattern first, reverse the order of the steps.

Umbrellas and privacy screens

Add shade and privacy

Enjoying life outdoors means being exposed to all of nature's pros and cons — not to mention neighbors or city life in general. Umbrellas help shield you from the elements and provide ultraviolet (UV) protection. Some of our umbrellas are water repellent, so you're protected against a light, passing rain shower. Privacy screens help keep eyes away to give you more peace of mind.

All our umbrellas have polyester fabric with UV protection. Here's what our different sun protection scales mean:

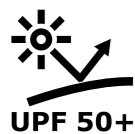

UPF 50+

Excellent protection 50+ fabric has a UPF (Ultraviolet Protection Factor) rating of 50+, which means it blocks 98% of the ultraviolet radiation.

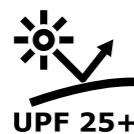

UPF 25+

Very good protection 25+ fabric has a UPF (Ultraviolet Protection Factor) rating of 25+, which means it blocks 96% of the ultraviolet radiation.

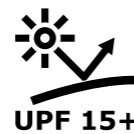

UPF 15+

Good protection 15+ has a UPF (Ultraviolet Protection Factor) rating of 15+, which means it blocks 93% of the ultraviolet radiation.

Please be aware: The umbrella does not provide protection against reflected or scattered solar ultraviolet radiation.



Umbrellas



SAMSÖ Umbrella, tilting Powder-coated steel and 100% polyester. Imported. Fabric: UPF 25+. Fits into HUVÖN umbrella base 17¾". Ø78¾, H65/90½". Pole Ø1¼".

Beige	503.118.15
-------	------------



TVETÖ Umbrella, tilting Powder-coated steel and 100% polyester. Fabric weight: .31 oz/sq.ft. Fabric: UPF 25+. The hook-and-loop strap keeps the fabric in place when folded. Fits into HUVÖN umbrella base 17¾". Requires assembly. Pole Ø1¼". L70¾xW57¾". H59-86¾".

Gray-beige white	804.688.57
------------------	------------



KUGGÖ/LINDÖJA Umbrella, tilting Powder-coated aluminum and 100% polyester. Imported. Fabric weight: beige 0.66 oz/sq.ft., black and beige-green 0.59 oz/sq.ft. Fabric: UPF 50+. The umbrella canopy can be removed and machine washed. Fits into HUVÖN 22" or GRYTÖ umbrella base. Requires assembly. Ø118¾, H94¾". Pole Ø1½".

Beige	092.689.52
Black	892.689.53
Beige-green	794.135.40



HÖGÖN Umbrella Powder-coated aluminum and 100% polyester. Imported. Fabric weight: 0.56 oz/sq ft. Fabric: UPF 25+. The umbrella canopy can be removed and machine washed. Fits into HUVÖN 22" or GRYTÖ umbrella base. Requires assembly. Ø106¾, H94¾". Pole Ø1½".

White	204.114.30
Gray	605.157.51



BETSÖ/LINDÖJA Umbrella, tilting Powder-coated aluminum, steel and 100% polyester. Fabric weight: beige 0.66 oz/sq.ft., black and beige-green 0.59 oz/sq.ft. Fabric: UPF 50+. The umbrella canopy can be removed and machine washed. Fits into HUVÖN 22" or GRYTÖ umbrella base. Requires assembly. Ø118¾, H95¾", pole Ø1¾".

Brown wood effect/beige	593.247.24
Brown wood effect/black	693.247.28
Brown wood effect/beige-green	394.135.75



KUGGÖ/VÄRHOLMEN Umbrella, tilting Powder-coated aluminum, steel and 100% polyester. Fabric weight: 0.82 oz/sq.ft. Fabric: UPF 50+. The umbrella canopy can be removed and machine washed. Fits into HUVÖN 22" or GRYTÖ umbrella base. Requires assembly. Ø118¾, H94¾". Pole Ø1½".

Beige	393.247.20
Gray/dark gray	294.136.32



BETSÖ/VÄRHOLMEN Umbrella, tilting Powder-coated aluminum, steel and 100% polyester. Fabric weight: 0.82 oz/sq.ft. Fabric: UPF 50+. The umbrella canopy can be removed and machine washed. Fits into HUVÖN 22" or GRYTÖ umbrella base. Requires assembly. Ø118¾, H95¾", pole Ø1¾".

Brown wood effect/beige	693.203.63
Brown wood effect/dark gray	994.136.19

Hanging umbrellas



OXNÖ/LINDÖJA Umbrella, hanging, tilting Powder-coated aluminum and 100% polyester. Imported. Fabric weight: beige 0.66 oz/sq.ft., black and beige-green 0.59 oz/sq.ft. Fabric: UPF 50+. The umbrella canopy can be removed and machine washed. Must be completed with SVARTÖ umbrella base (or with four concrete slabs, min. size 20x20", total weight min. 200 lbs). Requires assembly. Ø118¾, H104¾".

Beige	092.914.53
Black	392.914.61
Beige-green	694.135.93



HÖGÖN Umbrella, hanging Powder-coated steel and 100% polyester. Fabric weight: .56 oz/sq.ft. Fabric: UPF 25+. Must be completed with SVARTÖ umbrella base (or with four concrete slabs, min. size 20x20", total weight min. 200 lbs). Requires assembly. Ø106¾, H94¾".

White	004.453.51
Gray	505.157.42



OXNÖ/VÄRHOLMEN Umbrella, hanging, tilting Powder-coated aluminum, steel and 100% polyester. Fabric weight: 0.82 oz/sq.ft. Fabric: UPF 50+. The umbrella canopy can be removed and machine washed. Must be completed with SVARTÖ umbrella base (or with four concrete slabs, min. size 20x20", total weight min. 200 lbs). Ø118¾, H104¾".

Gray/beige	093.257.40
Gray/dark gray	294.136.13



SEGLARÖ Umbrella, hanging, tilting Powder-coated aluminum and 100% polyester. Imported. Fabric weight: 0.66 oz/sq.ft. Fabric: UPF 50+. You can easily turn the umbrella to shade different areas since it can be rotated 360 degrees. Must be completed with SVARTÖ umbrella base (or with four concrete slabs, min. size 20x20", total weight min. 200 lbs). Requires assembly. L129¾xW94½xH102¾".

Beige	303.878.68
Gray	604.759.72



SEGLARÖ Umbrella canopy 129¾x94½". Use as an extra canopy for SEGLARÖ hanging umbrella, if you purchased your SEGLARÖ after 2018.

Beige	005.002.05
-------	------------

Umbrella bases



GRYTÖ Umbrella base Polypropylene plastic. Fits following umbrellas: KUGGÖ/LINDÖJA, KUGGÖ/VÄRHOLMEN, BETSÖ/LINDÖJA, BETSÖ/VÄRHOLMEN, HÖGÖN, SAMSÖ. The umbrella base must be completely filled with sand. Approximately one cubic foot of sand is needed (approx. 77 lbs). Requires assembly. Ø23¾, H16¾". Max pole Ø2", min. pole Ø1".

Dark gray	903.146.90
-----------	------------



HUVÖN Umbrella base Concrete. Fits following umbrellas: KUGGÖ/LINDÖJA, KUGGÖ/VÄRHOLMEN, BETSÖ/LINDÖJA, BETSÖ/VÄRHOLMEN, HÖGÖN and SAMSÖ. L22xW22xH15". Max pole Ø2", min. pole Ø2". Weight: 88 lbs.

Gray	504.571.05
------	------------



HUVÖN Umbrella base Concrete. Fits following umbrellas: TVETÖ and SAMSÖ. L17¾xW17¾xH13". Max pole Ø1", min. pole Ø1". Weight: 46 lbs.

Gray-beige	904.571.08
------------	------------



BRAMSÖN Umbrella base Concrete and plastic. Fits FLISÖ umbrella. Requires assembly. L15¾xW11¾". Max pole Ø2", min pole Ø1". Weight: 33 lb 1 oz.

Black	902.657.60
-------	------------



SVARTÖ Umbrella base Polypropylene plastic. Fits hanging umbrellas with cross base. The umbrella base must be completely filled with sand. Approximately 50 lbs of sand (1.25 sand bags of 40 lbs each) are needed to fill each of the four sections, giving a total weight of about 200 lbs. Requires assembly. L39xW39xH4¾".

Dark gray	102.853.28
-----------	------------

For easier care and longer life

To make an umbrella canopy that could be cleaned in the washing machine, we took one apart. KUGGÖ, BETSÖ and OXNÖ umbrella frames consist of the pole and the canopy's ribs. They can tilt too! LINDÖJA and VÄRHOLMEN umbrella canopies easily fit onto KUGGÖ,

BETSÖ and OXNÖ umbrella frames. The detachable canopy comes in beige, black or dark blue, so you can change up the umbrella's look. Add a base for stability, and you're ready for lazy days in the shade.

How to build an umbrella

First decide if you wish to have a "standing" umbrella, KUGGÖ or BETSÖ, or a hanging umbrella, OXNÖ. The choice depends on how much space you have and wish

to shade, but also which look you prefer. A hanging umbrella has the advantage of no pole that blocks your view or gets in the way.

Choose umbrella frame

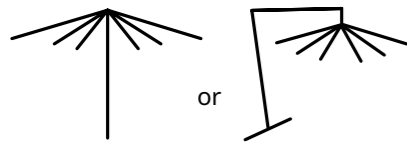

Choose umbrella canopy

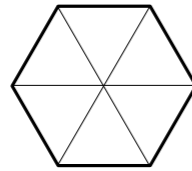

Choose umbrella base

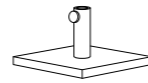

How to combine

In below overview you'll find which umbrella canopies and umbrella frames are sold separately and are possible to combine. To make it as easy as possible for

you, we have also created ready-made combinations. You'll find them all on the previous spread, pg. 80.

Umbrella	Umbrella canopy		Umbrella base				
	VÄRHOLMEN	LINDÖJA	HUVÖN 22"	HUVÖN 17 3/4"	GRYTÖ 23 3/4"	BRAMSÖN 15 3/4 x 11 3/4"	SVARTÖ 39 x 39"
BETSÖ umbrella frame 118 1/2"							
KUGGÖ umbrella frame 118 1/2"							
OXNÖ umbrella frame hanging (X base) 118 1/2"							
FLISÖ umbrella (balcony) 63 x 39 3/4"							
TVETÖ umbrella 70 1/2 x 57 1/2"							
SAMSÖ umbrella 78 3/4"							
HÖGÖN umbrella 106 1/4"							
HÖGÖN umbrella hanging (X base) 106 1/4"							
SEGLARÖ umbrella hanging (X base) 129 1/2 x 94 1/2"							

Privacy screens



SOLIG Net 100% polyester. Imported. Requires assembly. Ø59, H118 1/2".
White 101.481.57



YTTERSKÄR Privacy screen 100% polyester. Imported. Requires assembly. 72 1/2 x 59".
Gray 404.951.36

Umbrella cover

To protect your umbrellas from dirt, sun, rain, dust and pollen when not in use, we recommend you use TOSTERÖ waterproof cover.



TOSTERÖ Umbrella cover L86 5/8". Ø13 3/4-15". Fits the following umbrellas: OXNÖ/LINDÖJA and SEGLARÖ.
Black 603.245.63



TOSTERÖ Umbrella cover L63". Ø15 3/4-23 3/4". Fits the following umbrellas: SAMSÖ and FLISÖ.
Black 503.050.70

Outdoor lighting

Light a cozy night

Just because the sun goes down doesn't mean the fun has to stop! Turn on the lights wherever you are and set the mood you want with outdoor lighting. We have lamps — pendant, table, floor — lighting chains and lanterns. Almost all of our SOLVINDEN lighting uses solar cells to transform sunlight into electricity, so they won't add to your bills and don't use untidy cables and plugs.



Table and floor lamps

New



SOLVINDEN LED decorative table light Built-in LED light source. Requires 2-AAA batteries, sold separately. Polypropylene and plastic. Requires assembly. Ø3, H6".

White	605.136.86
-------	------------

New



VAPPEBY Bluetooth speaker lamp. It has a built-in rechargeable battery and is rainproof. Includes battery charger. Polypropylene and plastic. Ø7, H10". Available Spring 2022

Blue	405.152.76
Gray	405.152.81



STORHAGA LED table lamp Reminiscent of kerosene lamps of the past. It is dimmable and very flexible — it can be used indoors and outdoors and with cord or rechargeable batteries. Perfect for your balcony or patio. 3.5 W. Glass and steel. Requires assembly. Ø6, H14".

Black	304.327.38
-------	------------

New



SOLVINDEN LED decorative table light Built-in LED light source. Requires 2-AA batteries, sold separately. Polypropylene and plastic. Requires assembly. W4, H5".

Red	405.147.19
-----	------------

New



SOLVINDEN LED decorative table light Built-in LED light source. Requires 2-AA batteries, sold separately. In/outdoor. Glass and steel. Requires assembly. Ø4, H5".

	205.146.02
--	------------

Lanterns



BORRBÝ Lantern for block candle In/outdoor. Steel and glass.

L6×W6×H11". Black	101.561.09
L6×W6×H11". White	302.701.42
L9½×W9½×H17¼". Black	701.561.11
L9½×W9½×H17¼". White	902.701.44



ENRUM Lantern for tealight In/outdoor. Steel and glass. H8¾".

Black	604.451.12
Red	904.949.50

Lighting chains and decorations

New



LEDLJUS LED string light with 24 lights Built-in LED light source. Polycarbonate plastic. Requires assembly. Total L24'7".

Black	003.574.53
-------	------------

New



LEDLJUS LED string light with 64 lights Built-in LED light source. Polycarbonate plastic. Requires assembly. Total L44'3".

Black	803.574.54
-------	------------

New



UTSUND LED string light with 12 lights Built-in LED light source. Requires 3-AA batteries, sold separately. Plastic. Requires assembly. Total L16'1".

Black	004.211.33
-------	------------

New

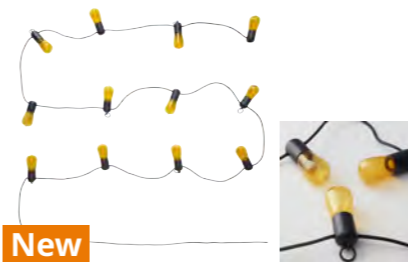

SOLVINDEN LED string light with 24 lights Built-in LED light source. Polycarbonate plastic. Requires assembly. Total L27'7".

Yellow	405.186.37
--------	------------

New



SOLVINDEN LED string light with 12 lights Built-in LED light source. Requires 3-AA batteries, sold separately. Includes LED driver. Polycarbonate plastic. Requires assembly. Total L16'1".

White	405.139.89
-------	------------

SVARTRÅ LED string light with 12 lights Built-in LED light source. Includes transformer. Polycarbonate plastic. Requires assembly. Total L27'7".

Black	203.908.28
-------	------------

New



SOLVINDEN LED string light with 12 lights Built-in LED light source. Requires 3-AA batteries, sold separately. Includes LED driver. Polycarbonate plastic. Requires assembly. Total L11'10".

Star	105.146.93
------	------------

New

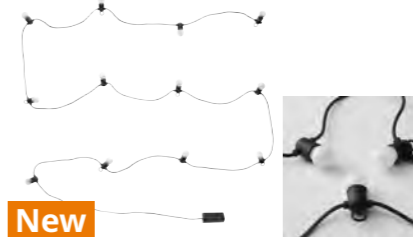

SOLVINDEN LED string light with 12 lights Built-in LED light source. Requires 3-AA batteries, sold separately. Includes LED driver. Polycarbonate plastic. Requires assembly. Total L16'1".

White	405.139.89
-------	------------

New



SOLVINDEN LED string light with 12 lights Built-in LED light source. Requires 3-AA batteries, sold separately. Includes LED driver. Polycarbonate plastic. Requires assembly. Total L11'10".

Shell	505.146.48
-------	------------

Outdoor flooring and rugs

Transform your space

If you've ever unrolled a new rug or redone your indoor flooring, you know the difference it can make. The same goes for your outdoor space. Instantly upgrade your balcony, section off an area for dining, or give your feet a break from the heat with outdoor rugs and any of our floor decking for outdoor use. In a variety of sizes, bold patterns and neutral colors, there's a rug to suit your style. UTLÄNGAN, RUNNEN, MÄLLSTEN and ALTAPPEN floor decking are easy to install by clicking the parts together. MÄLLSTEN and RUNNEN can even be combined to create your own unique look. Mix and match different colors and materials of RUNNEN and MÄLLSTEN — the possibilities are endless.

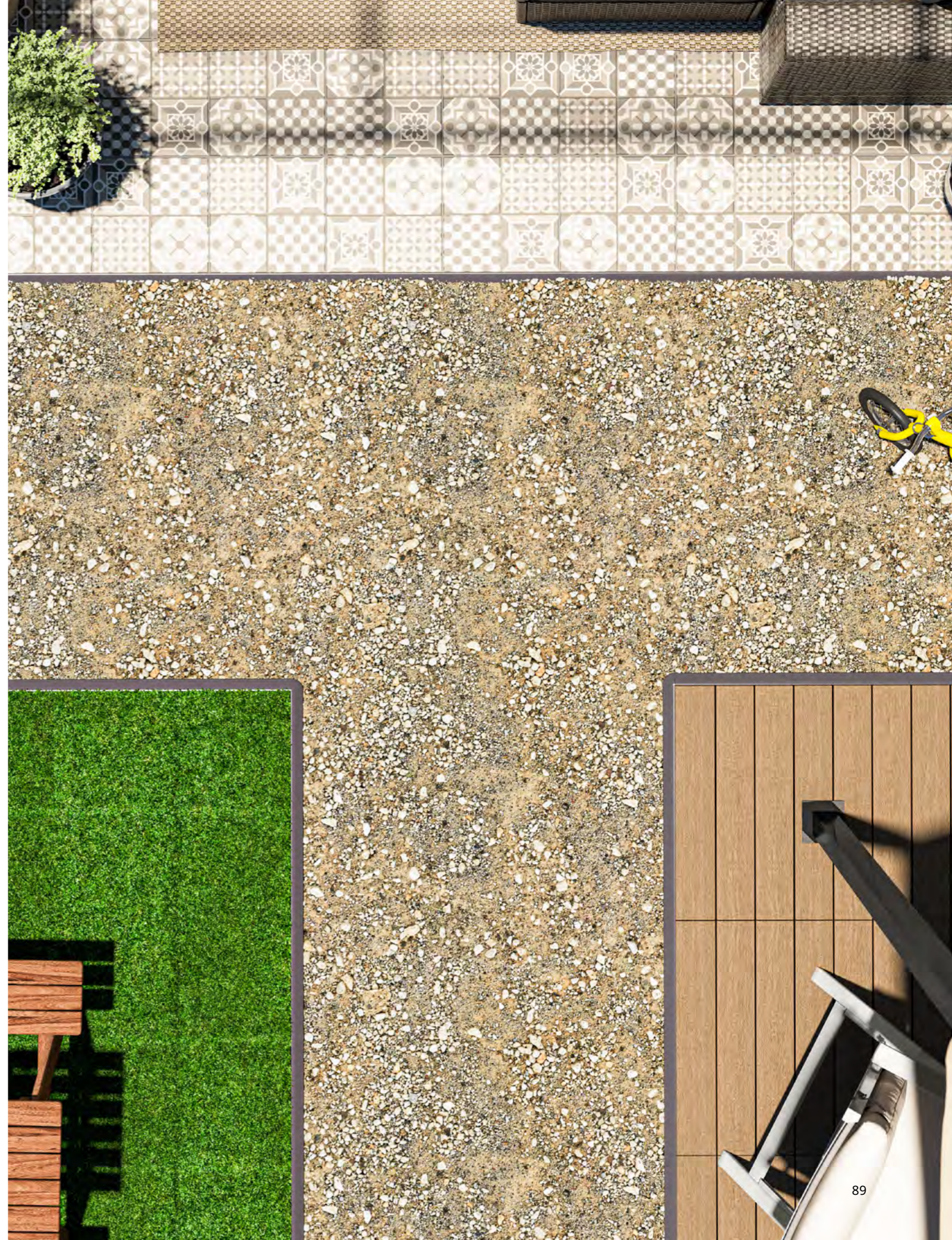

Outdoor flooring

Quickly create a personal look with our range of outdoor floor decking in different materials and colors. They click together so it is easy to upgrade your outdoor flooring. You can even combine

MÄLLSTEN, the new Marrakesh-style floor decking in weatherproof porcelain, with RUNNEN in different colors and materials to enhance the unique look.

Create your personal outdoor flooring

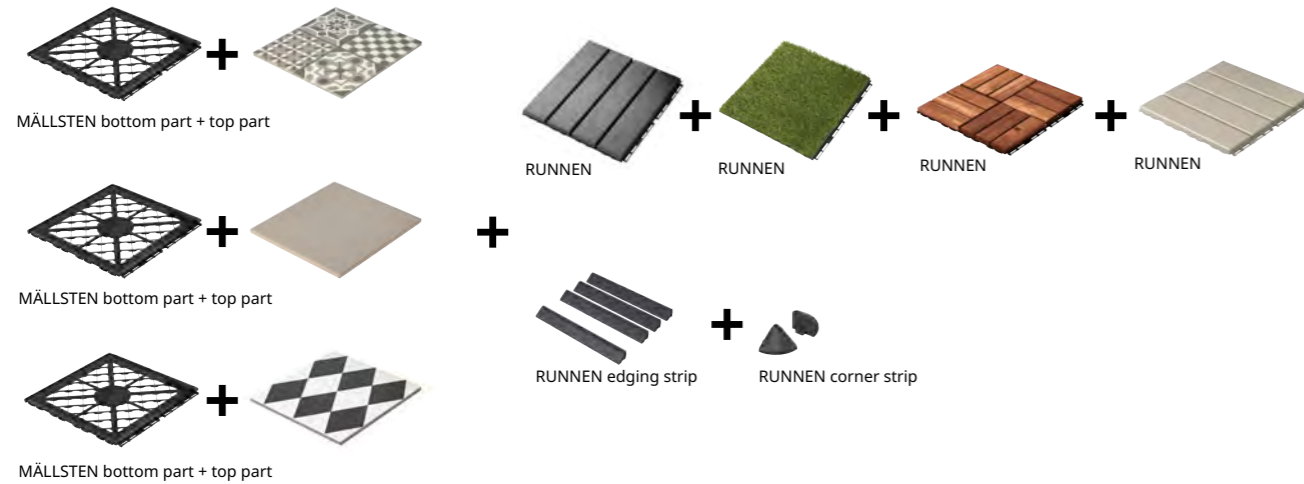

	ALTAPPEN	RUNNEN	RUNNEN edging strip, RUNNEN corner strip	MÄLLSTEN
Can be combined with:	ALTAPPEN	RUNNEN, MÄLLSTEN	RUNNEN, MÄLLSTEN	MÄLLSTEN, RUNNEN
Size:	11¾×11¾"	11¾×11¾"	11¾×11¾", 1½×11¾"	11¾×11¾"
Package quantity:	9 pieces	9 pieces	4 pieces (edging strip), 2 pieces (corner strip)	9 pieces bottom part + 9 pieces top part



Calculate how many packages you need:

To calculate your outdoor area, multiply the length by the width.

Example: W3'×L5' = 15 ft²

Calculate any areas to be subtracted from the total area, e.g. for pillars or corners.

Example:
Corner W6"×L1' = .5 ft²
15 ft² - 0.5 ft² = 14.5 ft²

Divide the sum by 0.81 for the square tiles and round up (to ensure enough floor decking):

Example:
14.5 ft² ÷ 0.81 = 17.9 ft²
Rounded up to 18 packages.

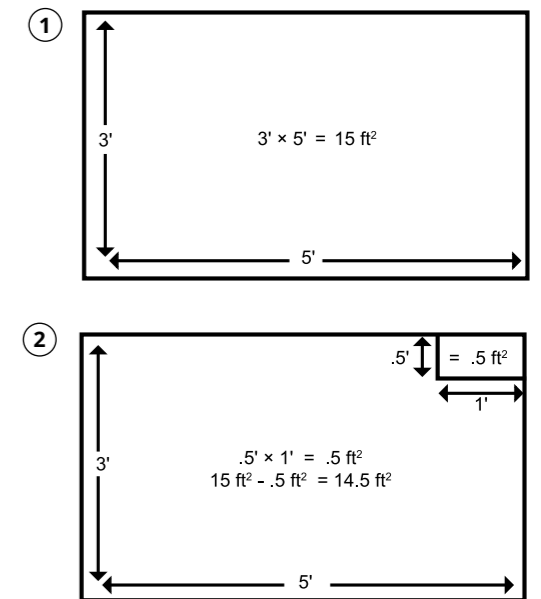

Here is a guide with ready-made calculations:

Size of area	Number of packages
26.16 ft ²	3 packages
61.04 ft ²	7 packages
78.48 ft ²	9 packages
113.36 ft ²	13 packages
130.8 ft ²	15 packages
200.56 ft ²	23 packages
218 ft ²	25 packages
270.32 ft ²	31 packages
322.64 ft ²	37 packages



RUNNEN and ALTAPPEN floor decking can be cut to fit it around a corner or a pole.

Outdoor flooring



RUNNEN Floor decking, outdoor One pack is nine pieces (11¼×11¼") of floor decking for outdoor use. 8.72 sq.ft. total. L11¼×W11¼×H¾"/ea piece. May be combined with RUNNEN and MÄLLSTEN floor decking in different colors and materials. Requires assembly.

Dark gray plastic	902.381.11
Beige	904.767.34

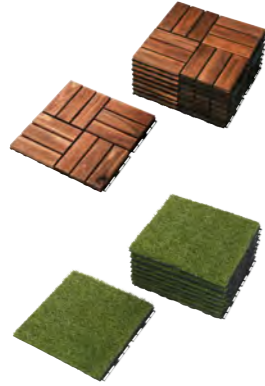

Brown stained acacia	902.342.26
Artificial grass	503.131.31



MÄLLSTEN Floor decking, outdoor 8.72 sq.ft. total. L11¼×W11¼×H¾"/ea piece. Porcelain and plastic. May be combined with RUNNEN and MÄLLSTEN floor decking in different colors and materials. Includes: nine top parts and nine bottom parts outdoor floor decking (11¼×11¼"). Requires assembly.

Gray/white	004.453.32
Black/white	105.089.08



ALTAPPEN Floor decking, outdoor One pack is nine pieces (11¼×11¼") of floor decking for outdoor use. 8.72 sq.ft. total. L11¼×W11¼×H¾"/ea piece. Polypropylene plastic. Can only be combined with ALTAPPEN floor decking. Requires assembly.

Light gray	904.208.98
------------	------------



RUNNEN Edging strip, outdoor floor decking. To be completed with any color of RUNNEN and MÄLLSTEN floor decking. Polypropylene plastic. Requires assembly. 11¼×1½×¾".

Dark gray	504.941.41	4pk
-----------	------------	------------



RUNNEN Corner edge, outdoor floor decking. To be completed with RUNNEN edging strip and any color of RUNNEN and MÄLLSTEN floor decking. Polypropylene plastic. Requires assembly. 1½×1½×¾".

Dark gray	104.941.38	2pk
-----------	------------	------------



RUNNEN
Floor decking, outdoor,
dark gray. Plastic. Requires
assembly. 8.72 sq ft. 902.381.11
9pk

Outdoor rugs

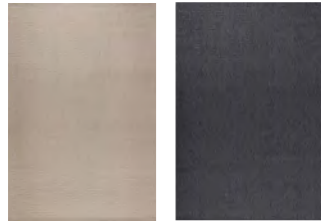

MORUM Rug, flatwoven In/outdoor. Brings a sense of calm to any room, and why not give your outdoor area an upgrade? Easy to clean and durable enough to withstand the elements of weather. 100% polypropylene surface. Synthetic latex backing. Imported. W6'7"×L9'10".

Beige	801.982.95
Dark gray	301.982.93



MORUM Rug, flatwoven In/outdoor. 100% polypropylene surface. Synthetic latex backing. Imported. W5'3"×L7'7".

Beige	202.035.63
Dark gray	402.035.57

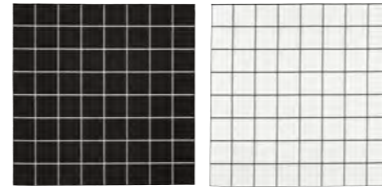

SVALLERUP Rug, flatwoven In/outdoor. A soft rug with a classic black and white square pattern. A great fit under your dining table since it's double-sided — if you spill, you can simply turn the rug over, which helps it withstand more wear and last even longer. 100% polypropylene. Imported. 6'7"×6'7".

Black/white	504.352.17
-------------	------------



New

VRENSTED Rug, flatwoven In/outdoor. This rug will serve its purpose wherever you like. Made from easy-care polypropylene that can handle wear and tear. Reversible so you can switch the look every now and then, and it will last even longer. 100% polypropylene surface. Synthetic latex backing. Imported. W4'4"×6'5".

Beige/light blue	204.951.99
------------------	------------



RODELUND Rug, flatwoven In/outdoor. The faded look brings a casual and relaxed feeling to your dining or outdoor area. Easy to care for and will endure everyday wear, spills, rain or shine. You can use both sides of the rug, so by turning it over now and then it will withstand more wear and last even longer. 100% polypropylene. Imported. W6'7"×L8'2".

Beige	504.458.91
-------	------------



HODDE Rug, flatwoven In/outdoor. A durable, stain-resistant rug that works just as well indoors as in the rain or shine on the balcony. It also has two lives since the rug is reversible and has the same pattern on both sides. 100% polypropylene. Imported. W6'7"×L9'10".

Gray/black	202.987.97
------------	------------

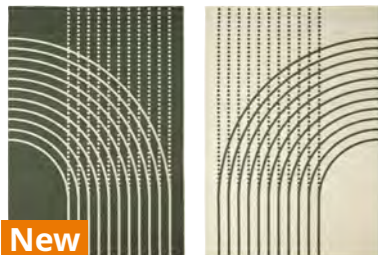

New

TÖMMERBY Rug, flatwoven In/outdoor. You can turn it over for a reversed color pattern, and then it will withstand more wear and last even longer. Modern art or a playful pattern reminiscent of a running track. 100% polypropylene surface. Imported. W5'3"×7'7".

Dark green/off-white.	004.952.04
-----------------------	------------



New

VIRKLUND Rug, flatwoven In/outdoor. A versatile rug with classic stripes that goes just about anywhere. If you want a new look after a while, just flip it over and use the compatible pattern on the reverse side. 100% polypropylene surface. Imported. W5'3"×7'7".

Beige/dark gray	505.179.44
-----------------	------------

Outdoor runners

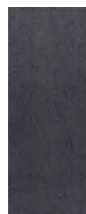

MORUM Rug, flatwoven In/outdoor. 100% polypropylene surface. Synthetic latex backing. Imported. W2'7"×L6'7".

Dark gray	102.035.73
-----------	------------



LOBBÅK Rug, flatwoven In/outdoor. 100% polypropylene surface. Imported. W2'7"×L6'7".

Beige	704.236.85
-------	------------



New

VIRKLUND Rug, flatwoven In/outdoor. A versatile rug with classic stripes that goes just about anywhere — indoors or outdoors. If you want a new look after a while, just flip it over and use the compatible pattern on the reverse side. Imported. W2'7"×L4'11".

White/beige/dark gray	005.179.46
-----------------------	------------

Door mats



KRISTRUP Door mat Indoor. Made from recycled PET bottles. 100% polyester surface. Synthetic rubber backing. W12"×L1'10".

Dark blue	903.924.52	99¢
-----------	------------	-----



YDBY Door mat In/outdoor. Polypropylene. W1'11"×L2'7".

Black	102.305.62
-------	------------



TRAMPA Door mat Indoor. Coir/polyethylene surface. Latex backing. Imported. W2'0"×L2'11".

Natural	200.521.87
---------	------------



SINDAL Door mat Indoor. 100% coir. Natural latex backing. Imported. W1'8"×L2'7".

Natural	800.476.35
---------	------------



OPLEV Door mat In/outdoor. 100% polypropylene surface. 100% synthetic rubber backing. Imported. W1'8"×L2'7".

Gray	303.089.94
------	------------

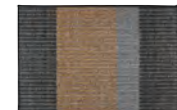

LYNDERUP Door mat In/outdoor. 100% polypropylene surface. 100% synthetic rubber backing. Imported. W2'0"×L2'11".

Multicolored	303.827.76
--------------	------------



Outdoor cooking

Turn up the heat

Veg. Fish. Pineapple. What's today's special? Get cooking outdoors with a barbecue that's right for you. You'll find barbecues, carts and kitchen islands to store oils and herbs close at hand and have dishes and bowls ready for serving — straight from the grill to the table. With new GRILLSKÄR series you can even build a complete outdoor kitchen to also do the clean up afterwards, just like your indoor kitchen. The barbecues have smart features like built-in thermometers, high-grade stainless steel cooking grates, pull-out ash trays and heat-insulated handles.





Go classic with charcoal

A charcoal barbecue provides extra smoky flavor loaded with that traditional feel. Using charcoal or briquets, you can create a hot zone for direct cooking and a cooler zone for indirect cooking. You can even bake, use a wok or cook pizza. In general, charcoal barbecues can reach higher temperatures than gas but take longer to reach cooking temperature. We recommend

that after lighting you wait 30-40 minutes — or until the coals are covered with gray ash — before putting on your food. You can regulate the overall temperature using the vent on the hood and on the front of the barbecue. When you're done, put out the coals by closing the hood and vent.

Good to know



1. The built-in thermometer on the hood helps you check the temperature during grilling — without having to lift the hood.
2. To get the desired grill temperature you can regulate the air flow by adjusting the stainless steel vent on the hood and on the front of the barbecue.
3. The cooking grate is durable and rustproof, as it is made of high-grade stainless steel.

4. Heat-insulated handle in stainless steel.
5. The ash tray can be pulled out, so it's easy to empty the ashes once you have finished grilling.
6. On the shelves under the grill there is space for accessories, utensils, serving platters and other things you need in order to serve smoking hot food directly from the grill to the table.

GRILLSKÄR outdoor kitchen

With the flexible modules in the GRILLSKÄR series you can customize your own outdoor kitchen with plenty of storage and an efficient workspace to prepare food, cook it and clean up afterwards. You can build in a

straight, L or U shape. Maybe you can even fit a kitchen island? Unleash your creativity and create your own outdoor dream kitchen with below units or choose a ready-made combination.

GRILLSKÄR units



GRILLSKÄR Charcoal grill with cabinet Distribute charcoal or briquettes in the grill to create a hot zone for direct cooking or a cooler zone for heat retention for when you want to grill food with different cooking times. Heat-insulated handles. Stainless steel. Requires assembly. W24×L33½×H44¾".

Black 304.714.47



GRILLSKÄR Gas grill with cabinet The built-in thermometer on the hood helps you check the temperature during grilling — without having to lift the hood. The cooking grate is durable and rustproof. Heat-insulated handles. Stainless steel. Requires assembly. W24×L23½×H47¼".

Black 004.899.34



GRILLSKÄR Door/side units/back By mounting these doors with back/side panels on GRILLSKÄR kitchen island and sink unit, you transform the open shelves into closed cabinets for your outdoor kitchen. Your utensils, serving platters and bowls are protected behind the doors and are ready to use for the next BBQ. The doors close tightly and are kept closed by a magnetic lock. Stainless steel. Requires assembly. L33½×W24×H36¼".

Black 104.714.48



GRILLSKÄR Sink unit If you want running water outdoors, just connect the sink unit to a clean garden hose. Perfect to have close to the grill so you can prepare food and place dirty bowls, plates and knives in the sink bowl to keep the work surface free. Just as you do in your indoor kitchen. There is plenty of space on the shelves for barbecue tools and bowls. To be completed with a faucet of your choice approved for outdoor use, sold separately. Stainless steel. Requires assembly. L33½×W24×H36¼".

Black 704.896.62



GRILLSKÄR Kitchen island shelf unit This kitchen island gives you extra storage space and a good work surface where you can prepare food before it's time to put it on the grill. On the shelves there is plenty of space for plates, glasses, utensils, oils and other things you need for the BBQ. The movable shelf is made of steel and has a durable, powder-coated surface that is easy to wipe dry. Stainless steel. Requires assembly. L33½×W24×H36¼".

Black 504.714.46

GRILLSKÄR ready-made combinations



GRILLSKÄR Kitchen sink unit/kitchen island/charcoal barbecue Stainless steel. L101½×W24×H44¾".

Black 394.308.34



GRILLSKÄR Kitchen sink unit/kitchen island/charcoal barbecue To be completed with a faucet of your choice approved for outdoor use, sold separately. Stainless steel. L67½×W48×H44¾".

Black 094.308.35



GRILLSKÄR Kitchen with charcoal barbecue Stainless steel. Requires assembly. L67½×W24×H44¾".

Black 393.849.88



GRILLSKÄR Kitchen sink unit/kitchen island/charcoal barbecue To be completed with a faucet of your choice approved for outdoor use, sold separately. Stainless steel. L101½×W57½×H44¾".

Black 894.308.36

Outdoor cooking utensils



GRILLTIDER BBQ brush Silicone.

L9¾" 004.445.54



GRILLTIDER Squeeze bottle Plastic. 11 oz. Transparent

Ø2, H7¾" 804.446.06 2pk



New

GRILLTIDER 3-piece barbecue tools set Dishwasher-safe. Available Spring 2022

Stainless steel 005.168.62 set of 3



New

GRILLTIDER Barbecue grill cleaning brush W5½×L15". Available Spring 2022

Stainless steel 405.165.39



New

GRILLTIDER Hamburger press Aluminum, fluorine plastic. Ø4¾, H2¾".

905.165.46



Gardening

Grow your own

Plants make people happy and improve your general well-being. From a small window to a big backyard, you can grow plants anywhere. We have lots of pots to choose from, including several made for indoor and outdoor use. Necessities like gardening tools and spray bottles help you tend to your garden — and greenhouses, plant stands, trellises and more can maximize your growing area. If you want greenery that's as effortless as can be, fake it with our lifelike FEJKA artificial plants and flowers that last and last. When you're ready to get growing, remember patience is part of the process, too.



Gardening tools



New

GRÄSMARÖ 3-piece gardening tool set Includes one of each: trowel, hand rake and bulb trowel. Reinforced polyamide. L8¾".

Light gray/light green 005.053.78 **set of 3**



ODLA Growing media clay pebbles

5.3 qt 502.885.46



SOCKER Watering can In/outdoor. Galvanized steel. 88 oz, H9".

Galvanized 701.556.73



New

BRYTBÖNA Herb scissors Reinforced polypropylene and stainless steel. L6".

Light green 305.054.52



New

BRYTBÖNA Pruning shears Reinforced polypropylene and stainless steel. L7".

Light gray/light green 905.054.54



New

SOCKER Watering can In/outdoor. Powder-coated steel.

Red, 34 oz, H6" 805.114.36

Galvanized, 169 oz, H11½" 205.114.39



New

TOMAT Spray bottle Plastic. 12 oz, H10".

White 403.712.54

Pale blue 805.053.22



New

SOCKER Bucket/plant pot In/outdoor. Ø11", H10¾". 11 qt.

Galvanized 205.114.44

Outdoor pots



BOYSENBÄR Plant pot In/outdoor. Concrete. Light gray.

Max inner Ø3½". Ø4¼, H4". 904.782.76

Max inner Ø4¾". Ø5½, H5". 104.592.53

Max inner Ø6". Ø7, H6¼". 404.592.56

Max inner Ø7½". Ø8¾, H8¾". 704.675.56

Max inner Ø9½". Ø10¾, H10¾". 304.522.60



MUSKOTBLOMMA Plant pot with saucer In/outdoor. Terracotta.

Max inner Ø4¾". Ø6¼, H5". 004.548.83

Max inner Ø6". Ø7¾, H6¼". 304.548.91



NYPON Plant pot In/outdoor. Polypropylene plastic (min. 20% recycled). Gray.

Max inner Ø3½". Ø4, H4". 033.956.19

Max inner Ø5". Ø5½, H4¾". 403.956.17

Max inner Ø6". Ø6¾, H6". 603.956.16

Max inner Ø9½". Ø10¾, H9½". 003.956.24



New

VITLÖK Plant pot In/outdoor. Powder-coated galvanized steel. Off-white.

Max inner Ø9½". Ø10¾, H9¾". 605.053.61

Max inner Ø12½". Ø13¾, H13". 005.053.64



New

BRUNBÄR Plant pot with saucer Outdoor, terracotta.

Max inner Ø4¾". Ø5, H5". 105.108.26

Max inner Ø6". Ø7, H6¼". 705.108.28



RÄGKORN Plant pot In/outdoor. Polyethylene and PET plastic with natural look. Natural.

Max inner Ø9½". Ø11, H12¼". 004.075.56

Max inner Ø12½". Ø14½, H15¼". 404.075.59



New

CITRUSFRUKT Plant pot with saucer In/outdoor. Stoneware. Gray.

Max inner Ø3½". Ø4¼, H4". 805.084.34

Max inner Ø4¾". Ø6, H5". 505.084.35

Max inner Ø6". Ø6¾, H6¼". 205.084.32

Max inner Ø7½". Ø9, H8¾". Available Spring 2022

Max inner Ø9½". Ø11, H10¾". Available Spring 2022

105.108.31 105.084.37



SOCKER Plant pot In/outdoor. Galvanized steel.

Max inner Ø9½". Ø10¾, H9½". Additional sizes available, prices vary.

Galvanized 301.556.70



CHIAFRÖN Plant pot In/outdoor. Stoneware. White.

Max inner Ø4¾". Ø5½, H5". 504.757.60

Max inner Ø6". Ø6¾, H6¼". 604.757.93



FÖRENLIG Plant pot In/outdoor. Polypropylene plastic. White.

Max inner Ø3½". Ø4, H4". 704.548.13

Max inner Ø4¾". Ø5½, H4¾". 004.548.21

Max inner Ø9½". Ø10¾, H10¾". 404.548.19

OUTDOOR PLANTS

You will find a wide offer of seasonal outdoor plants in the Plant exhibition in the store.

Outdoor greenhouses, plant stands and trellises



HYLLIS Shelf unit In/outdoor. Galvanized steel. Requires assembly. W23¾×D10¾×H55¼".

002.785.78



HYLLIS Shelving unit In/outdoor. Galvanized steel. Requires assembly. W23¾×D10¾×H29¾".

304.283.26



ASKHOLMEN Plant stand Stained solid acacia. Requires assembly. W17¾×D12½×H45¾".

Light brown stained 102.586.69



ASKHOLMEN Trellis Stained solid acacia. Requires assembly. W28¾×D1¾×H74¾".

Light brown stained 702.586.71



ASKHOLMEN Flower box Stained solid acacia. Requires assembly. W24×D15×H15".

Light brown stained 302.586.73



VITLÖK plant stand In/outdoor. Powder-coated steel. Requires assembly. W24½×D11×H15".

Off-white 705.053.70



VITLÖK Flower box with holder In/outdoor. Powder-coated galvanized steel. W22×D7¾×H6¾".

Off-white 105.053.30



GALIAMELON Flower box with holder In/outdoor. PET plastic and powder-coated steel. W20×D7×H7".

White 205.052.02



OLIVBLAD Plant stands In/outdoor. Powder-coated steel. Requires assembly. Black.

Ø9, H13¾" 104.866.52

W9¾×L21¾×H22" 104.866.47

Ø17¾, H22¾" 504.866.50

Seasonal pots and saucers



New

CHILIPEPPAR Plant pot In/outdoor. Polyethylene. Beige.

Ø12½, H16¼" 705.050.49

Ø16¼, H17¾" 705.050.54



New

CITRUSKRYDDA Plant pot In/outdoor. Polyethylene. Ø13¾, H11".

Gray 805.050.44



CURRYBLAD Plant pot Outdoor. Terracotta.

Ø10¼, H9¾" 105.050.71

Ø13¾, H13" 805.050.77

Outdoor artificial plants



FEJKA Artificial potted plant with pot In/outdoor. EVA plastic, polyethylene and paint. Polypropylene. Imported. Ø2¼, H4¾".

Succulent 505.197.64 3pk



FEJKA Artificial potted plant In/outdoor. Polyethylene. Imported. Ø3½, H27½".

Hanging 403.495.31



FEJKA Artificial plant Wall-mounted, in/outdoor. 100% polyester and polyethylene. Imported. 10¼×10¼".

Green/lilac 203.495.32



FEJKA Artificial potted plant In/outdoor. EVA plastic, steel and polyethylene. Imported. Ø4¾, H17¼".

Weeping fig on stem 003.953.08



FEJKA Artificial potted plant In/outdoor. 100% polyester and polyethylene. Imported. Ø4¾, H9¾".

Ranunculus pink 003.952.90



FEJKA Artificial potted plant In/outdoor. Polyethylene, 100% polyester and steel. Polypropylene and concrete. Imported. Ø6, H26½".

Eucalyptus 404.523.68



FEJKA Artificial potted plant In/outdoor. EVA plastic, steel and polyethylene. Imported. Ø7½, H35½".

Monstera 403.952.88



FEJKA Artificial potted plant In/outdoor. Polyethylene. Imported. Ø3½, H5".

String of bananas hanging 205.084.08



FEJKA Artificial potted plant In/outdoor. EVA plastic, steel and polyethylene. Imported. Ø4¾, H26¾".

Areca palm 305.084.03

Outdoor storage and organizing

Contain the clutter

Make more room to enjoy the outdoors. To hold anything from cushions and dishes to toys and sports equipment, little additions like hooks or a box can have as much of an impact as larger shelving units, cabinets, storage benches and carts. Open shelving units keep things readily accessible, while closed cabinets, storage benches (that double as seating) and TOSTERÖ storage bags and box shield stuff from the elements. Storage can't hold the nice weather, but it can help you spend more time having fun.



Shelving units and cabinets



HYLLIS Shelf unit In/outdoor. Galvanized steel. Max shelf load 35 lbs. Requires assembly. W15¾×D10¾×H72".

Gray 204.885.04



HYLLIS Shelf unit In/outdoor. Galvanized steel. Max shelf load 55 lbs. Requires assembly. W23¾×D10¾×H55¾".

Gray 002.785.78



LÄCKÖ Shelving unit Powder-coated steel. Max shelf load 53 lbs. Requires assembly. W24×D12¾×H63".

Gray 201.518.37



KOLBJÖRN Cabinet In/outdoor. Powder-coated galvanized steel. Requires assembly. W35¾×D13¾×H63¾".

Beige 203.456.33



KOLBJÖRN Cabinet In/outdoor. Powder-coated galvanized steel. Requires assembly. W31½×D13¾×H31¾".

Beige 304.092.95
Green 004.503.47



KOLBJÖRN Shelf unit In/outdoor. Powder-coated galvanized steel. Max shelf load 55 lbs. Requires assembly. W31½×D13¾×H31¾".

Beige 604.092.94
Green 404.503.50



TORDH Shelving unit, outdoor Solid acacia. Requires assembly. W82¾×D13¾×H35¾-63¾".

Brown stained 193.164.91



TORDH Shelving unit, outdoor Solid acacia. Requires assembly. W47¼×D13¾×H63¾".

Brown stained 693.164.17

Storage benches



ÄPPLARÖ Bench with panel and shelves Stained solid acacia wood and galvanized steel. Requires assembly. W31½×D17¾×H62¼".

Brown stained 298.979.79



ÄPPLARÖ Storage bench Stained solid acacia wood. Can be combined with TOSTERÖ storage bag for cushions. Requires assembly. W50¾×D22½×H21¾".

Brown stained 902.342.07

Outdoor boxes and bags



TOSTERÖ Storage bag for pads and cushions Fits in ÄPPLARÖ storage bench 50¾×22½". 100% polyester. Imported. L45¾×W19¼×H13¾".

Black 103.050.72



VRENEN Storage box Outdoor. Polypropylene. Requires assembly. W61¾×D28×H36¾".

Light gray/gray 504.114.43



Outdoor laundry

Hang dry, hang out

Chances are, you would rather be relaxing, but sometimes your outdoor area is for laundry duty, too. When that's the case, maximize your space! Whether you need an extra wide drying rack or one that folds up flat, we have different sizes and shapes to suit your needs. With baskets and hangers, your outdoor space can turn into a one-stop drying spot. Outdoor drying is gentle on clothes and textiles, which helps them last longer. Thanks to the wind and sun, your electric bills are lower, too.



Drying racks



MULIG Drying rack In/outdoor. Powder-coated steel. W68×D22½×H40½".

White 502.287.55



JÄLL Drying rack In/outdoor. Powder-coated steel and plastic. W31×D15¼×H32¼".

White 802.428.92

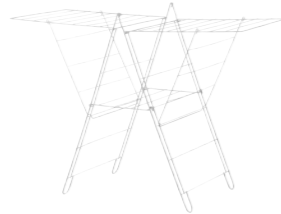

FROST Drying rack In/outdoor. Steel. W52¾×D23¼×H36½".

White 402.448.31



TURBO Clothes rack in/outdoor. Wood plastic composite. Requires assembly. W46¼×D23¼×H58¼".

Black 401.772.33



JÄLL Laundry bin EVA plastic. Stainless steel. W17×D16¼×H25¼". 18 gal.

White 701.189.68

Basket, pegs and hangers



TORKIS Flexi laundry basket In/outdoor. 9 gal. W22¾×H11". Polyethylene plastic.

Blue 803.392.24

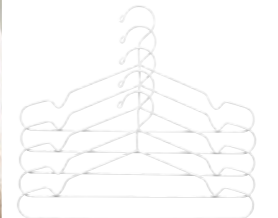

STAJLIG Hangers In/outdoor. A durable hanger that can be used indoors or for hanging clothes to air or dry outdoors. It takes up very little space in wardrobes so you have more space for your clothes. More than 30% (weight) of the metal content of this product is made from recycled steel. Powder-coated steel.

White 002.914.19 **5pk**



SPRUTTIG Hangers Pants hanger, skirt hanger and shirt hanger all in one. Polypropylene.

White 203.170.79 **10pk**

Maintenance



Easy-care furniture materials

Aluminum, plastic, plastic rattan and steel are maintenance-free outdoor furniture materials. Just make sure to keep the pieces clean with a mild soapy solution. Cover or store them away at the end of the season in a cool, dry place like a garage, carport or basement — especially plastic and plastic rattan pieces that can crack in freezing temperatures.

Little-extra-care furniture materials

Acacia, eucalyptus and other solid woods usually require a little care from time to time. Clean with a mild soapy solution, cover them when not in use and at the season's end, cover or store them away in a cool, dry place indoors. All our wooden outdoor furniture is pretreated with stain or paint. We recommend restaining to prevent cracking and extend its lifetime. How often you restain depends on location, usage and exposure to the elements. For example, furniture in open air needs restaining when rain drops are absorbed instead of forming small beads. If painted furniture begins to flake or look worn, repaint or touch up with paint for outdoor use.

Care for umbrellas

Fold your umbrella when not in use, so it will be sturdier against wind. Umbrellas typically need a thorough cleaning only once a year. Follow the wash label. We recommend protection from dirt, dust, pollen and rain with a cover like TOSTERÖ and storing it in a cool, dry place indoors. Ensure it is completely dry before covering.

Care for cushions and pads

To extend the life of your outdoor cushions and pads, clean them regularly. Follow the wash label. We recommend storing them away when not in use, preferably in a cool, dry place indoors. TOSTERÖ storage bags and box helps keep them in shape. Ensure the cushions are completely dry before you close the bag or box.





Covers and maintenance products

<p>TOSTERÖ Cover for furniture set 39$\frac{1}{2}$"xW27$\frac{1}{2}$"xH35$\frac{1}{2}$". Fits outdoor dining sets with a table and two chairs.</p> <p>Black 903.050.73</p>	<p>TOSTERÖ Cover for furniture set L57$\frac{1}{2}$"xW57$\frac{1}{2}$"xH47$\frac{1}{2}$". Fits outdoor dining sets with a table and four chairs.</p> <p>Black 803.050.64</p>	<p>TOSTERÖ Cover for furniture set L84$\frac{1}{2}$"xW53$\frac{1}{2}$"xH41$\frac{1}{2}$". Fits outdoor dining sets with a table and six chairs.</p> <p>Black 503.050.65</p>
<p>TOSTERÖ Cover for furniture set L110$\frac{1}{2}$"xW58$\frac{1}{2}$"xH42$\frac{1}{2}$". Fits outdoor dining sets with a table and eight chairs.</p> <p>Black 804.281.59</p>	<p>TOSTERÖ Cover for outdoor furniture L42$\frac{1}{2}$"xW33$\frac{1}{2}$"xH35$\frac{1}{2}$". Fits outdoor armchairs and easy chairs with max. width 43", max depth 34" and max. height 35".</p> <p>Black 304.279.25</p>	<p>TOSTERÖ Cover for outdoor furniture L66$\frac{1}{2}$"xW39$\frac{1}{2}$"xH34$\frac{1}{2}$". Fits outdoor 2-seat sofas with max. width 67", max. depth 39" and max height 34".</p> <p>Black 504.279.29</p>
<p>TOSTERÖ Cover for outdoor furniture L110$\frac{1}{2}$"xW65"xH33$\frac{1}{2}$". Fits, for example, outdoor 3-seat corner sofas and a coffee table or outdoor 3-seat sofas together with an armchair and a coffee table with total max. length 102", max. width 65" and max height 34".</p> <p>Black 704.114.99</p>	<p>TOSTERÖ Cover for chaise 78$\frac{1}{4}$"xW23$\frac{1}{2}$"xH15$\frac{1}{4}$".</p> <p>Black 903.050.68</p>	
<p>TOSTERÖ Storage bag for cushions L45$\frac{1}{2}$"xW19$\frac{1}{4}$"xH13$\frac{3}{4}$". Fits ÄPPLARÖ storage bench 50$\frac{1}{2}$"x22$\frac{1}{2}$".</p> <p>Black 103.050.72</p>	<p>VRENEN Storage box W61$\frac{1}{2}$"xH36$\frac{1}{2}$".</p> <p>Light gray/gray 504.114.43</p>	
<p>TOSTERÖ Umbrella cover L63". Max Ø23$\frac{1}{2}$", min. 15$\frac{3}{4}$". Fits the following umbrella: SAMSÖ.</p> <p>Black 503.050.70</p>	<p>TOSTERÖ Umbrella cover L86$\frac{1}{2}$". Max Ø15, min. 13$\frac{3}{4}$". Fits the following umbrellas: OXNÖ/LINDÖJA and SEGLARÖ.</p> <p>Black 603.245.63</p>	

Protect your outdoor pieces

With a little help from you, your outdoor furniture can have an extended life. In general, clean outdoor furniture regularly and avoid leaving it outdoors

unprotected more than necessary. If possible, use a waterproof cover like TOSTERÖ and store in a cool, dry place indoors when the season is over.



VÄRDA Wood stain Outdoor. 17 oz. Coverage 108 sq.ft. To add shine and protection but no color we recommend colorless VÄRDA wood stain. To refresh the color we recommend VÄRDA wood stain with pigment.

Colorless	203.331.02
Brown semi-transparent	403.331.01
Gray	904.676.78



FIXA Paint brush set Includes: one brush (width 1"), one brush (width 1 $\frac{1}{4}$ ") and one brush (width 2").

702.900.82 **3pk**

Made outdoor strong

When you're spending time outdoors, we want you to daydream, chit-chat, cat nap and savor delicious flavors. We don't want you to worry about the quality of your outdoor furniture. We've done all the thinking and researching for you, so your pieces will have long lifetimes. From choosing durable materials and adding extra protection against the elements, we treat every outdoor piece like we were bringing it home — in every kind of weather! Read more about our outdoor materials below.

Metals

All metal used in our outdoor furniture withstands rain, snow, low and high temperatures. Lightweight aluminum is a very durable, rustproof material even without any additional treatment. Steel is durable and protected against rust by a powder-coating of paint. Galvanized steel is coated in zinc for protection against rust, and we apply a powder-coating of paint, too.

Plastics

All our plastic and plastic rattan outdoor furniture will look fresh and new for longer because it is both UV stabilized and fade resistant. Plastic and handwoven plastic rattan are durable and withstand rain, snow, low and high temperatures. In freezing temperatures, they can weaken and are not recommended for use.

Solid woods

For maximum protection, all our outdoor wooden furniture is pretreated with wood stain. By restaining now and then you can enjoy it for many years. Acacia and eucalyptus are durable, sturdy hardwoods because of their high density of wood fibers.

Textiles and sunshine

To prevent as much fading as possible from the sun's UV rays, we introduced a production technique, called dope dyeing, for solid-colored fabric cushions. During the process, the color pigments become part of the fiber, improving color fastness. This reduces water consumption by 80% and dyestuff consumption by more than 20% compared to traditional dyeing techniques.

Textiles and rain

We don't use any non-degradable, perfluorinated chemicals on our umbrellas and outdoor cushions, which is better for you and the environment. As for water-repellent outdoor cushions, just shake off water from a light rain. If the forecast calls for weather heavier than a light, passing rain shower, we recommend putting your dry umbrella and cushions in our TOSTERÖ covers, bags and storage box. They'll be better protected, and you'll be able to enjoy them for more sunny days to come!



Relax, we can help

Ready to enjoy the outdoors? Get to the fun faster while we do the work. From picking and delivering your order to assembling your new outdoor sofa, our local services are waiting for you. We can even offer financing, too.



Delivery

Most of our products are designed and packaged so that you can take them home yourself. If you prefer, we can arrange for delivery of your purchases directly to your home or business. Same day, next day or same week deliveries are available. We can also arrange for delivery at a later date if you would like.



IKEA Projekt credit card

Your dream home is now within reach. With the special financing options on our IKEA Projekt credit card*, you don't have to put off loving every room in your home.

*Subject to credit approval.
IKEA Projekt Credit Card Accounts are issued by Comenity Capital Bank.
To learn more visit [IKEA-USA.com/creditcard](https://www.IKEA-USA.com/creditcard) or drop by your local store.



TaskRabbit Assembly

All IKEA products are designed to be assembled by you, but you don't have to. We've partnered with TaskRabbit to connect you with a network of independent 'Taskers' who can provide quick and convenient assembly and mounting services for your IKEA purchases made online and in stores. You can schedule assembly service for as soon as the same day, with the Tasker of your choice. Visit [TaskRabbit.com/IKEA](https://www.TaskRabbit.com/IKEA) or see a co-worker for more details.



SUNDSÖ
Table Ø25", foldable.
Chair, foldable. Grey/grey.
294.349.22



Furniture for you and the environment

Wood is a fantastic material that we've used since the start of IKEA in the Småland forests. We're a global company with clear rules for all wood we use and strive to ensure that our wood comes from more sustainable sources — certified or recycled. For the ÄPPLARÖ series in solid acacia, and all other outdoor furniture, we've already achieved this goal. They are robust pieces of furniture which have been produced in a way that is sustainable for people and the environment.

FEJAN
Chair, outdoor, foldable
17¾×16½×35", white.
102.553.07

